

ESTIMATE

Name Of Work :- Proposed Construction of 1000MT Warehouse Unit Building In G.no.138 Paiki, For Surya Tej Farmers Producer Co. Ltd., At- Saknewadi, Tal:-Osmanabad, Dist:- Osmanabad(MH)

Estimated Cost of Works (Rs.) :- 12002386.00

Rupees One Crore Twenty Lack Two Thousand Three Hundred Eighty Six Only.

(161)

SAI CONSULTANT'S

Consulting Civil Engineer's, Architects,
Builders & Developers, Govt. Contractors.

Shop No.2, Shradha Building, College Road,
Rahuri, Tal-Rahuri, Dist-Ahmednagar.

email:-saiconsultants333888@gmail.com
cell.9970253888,9881964333.



REF NO.:-

DATE :-

**Name Of Work :- Proposed Construction of 1000MT Warehouse Unit Building In
G.no.138 Paiki, For Surya Tej Farmers Producer Co. Ltd., At- Saknewadi, Tal:-
Osmanabad, Dist:- Osmanabad(MH)**

RECAPITULATION SHEET

| | | | |
|----|-------------------------------------|------------------------------|--------------------|
| 1 | S.W. I - W.H.Building | Rs. | 8662598.00 |
| 2 | S.W. II - Internal Bituminous roads | Rs. | 972847.00 |
| 3 | Add Royalty WH + Road | Rs. | 215049.72 |
| 4 | Add Testing Charges | Rs. | 23205.00 |
| 5 | Add.18.00 % GST W.H. Building | Rs | 1559268.00 |
| | | A) Total Rs. | 11432967.72 |
| 6 | Add. 3% Contigencies on Total | Rs | 342989.00 |
| 7 | Add. 1.00 % Insurance on Part A | Rs. | 114330.00 |
| | | Total Rs. | 11890286.72 |
| 8 | Sub Work No:-III Electrification | Rs. | 92644.00 |
| | | Total Rs. | 92644.00 |
| 9 | Add.18.00 % GST On Electrical Work | Rs | 16676.00 |
| 10 | Add. 3% Contigencies on Elecrical | Rs | 2779.00 |
| | | B) Total Rs. | 112099.00 |
| | | Grand Total (A+B) Rs. | 12002385.72 |
| | | Say Rs. | 12002386.00 |

Rupees One Crore Twenty Lack Two Thousand Three Hundred Eighty Six Only.

Bhaskar
Chartered Engineer
Gaurav Rajendra Bhaskar
B.E.(Civil) A.M.I.E.
Chartered Engineer
AM3023322

Bootha
Consulting Engineer
SAI CONSULTANT
Consulting Civil Engineer
Rahuri, Dist. Ahmednagar



Name Of Work :- Proposed Construction of 1000MT Warehouse Unit Building In G.no.138 Paiki, For Surya Tej Farmers Producer Co. Ltd., At- Saknewadi, Tal:-Osmanabad, Dist:- Osmanabad(MH)

S.W. I - W.H.Building

ABSTRACT

| Quantity | L.No | Item of work | Rate | unit | Amount |
|----------|------|---|---------|-------------|-----------|
| 130.08 | 1 | Excavation for foundation in earth, soil of all types, sand, gravel and soft murum, including removing the excavated material up to a distance of 50 m.beyond the building area & stacking and spreading as directed, dewatering, preparing the bed for the foundation and necessary back filling, ramming, watering Including shoring and strutting etc. complete. (LIFT UPTO 1.5 M.) By Mechanical Means | 207.00 | Cubic Metre | 26926.56 |
| 65.04 | 2 | Excavation for foundation in Hard murum in cluding removing the excavated material upto adistance of 50 metres beyond the building area and stacking and spreading as directed, dewatering, preparing the bed for the foundation and necessary backfilling, ramming, watering including shoring and strutting etc. complete. (Lift from 1.5 to 3.0m.) By Mechanical Means | 284.00 | Cubic Metre | 18471.36 |
| 146.03 | 3 | Providing dry trap/ granite/ quartzite/ gneiss rubble stone soiling 15 cm to 20 cm thick including hand packing and compacting complete. Spec.No. : Bd.A.12 Page No. 264 ; | 1662.83 | Cubic Metre | 242823.06 |
| 195.12 | 4 | Filling in plinth and floors with approved excavated material in 15cm. to 20cm. layersincluding watering and compacting etc. complete. | 120.00 | Cubic Metre | 23414.40 |
| 181.18 | 5 | Filling in plinth and floors with contractors material/ brought from outside and approved by Engineer in charge in layers of 15 cm to 20 cm including watering and compaction etc.complete. | 1047.22 | Cubic Metre | 189735.32 |
| 29.27 | 6 | Providing and filling in the foundation with sand of approved quality including watering, compacting etc. complete. (To be executed with prior approval of Superintending Engineer) | 2389.55 | Cubic Metre | 69942.13 |
| 65.26 | 7 | Providing and laying Cast in situ/ Ready Mix cement concrete in M-10 of trap/granite/quartzite/ gneiss metal for foundation and bedding including bailing out water, Steel centering, formwork, laying/pumping, compacting, roughening them if special finish is to be provided, finishing if required and curing complete ,with fully automatic microprocess or base dPLCwith SCADA enable dreversible Drum Type mixer/ concrete Batch mix plant (Panmixer) etc.complete. With fine aggregate (Crushed sand VSI Grade) | 6176.64 | Cubic Metre | 403087.53 |

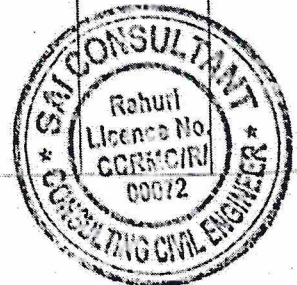

(16B)

| Quantity | I.No | Item of work | Rate | unit | Amount |
|----------|------|---|----------|-------------|-----------|
| 42.64 | 8 | Providing and laying in situ cement concrete of M-25 grade of trap / granite/quartzite/gneiss metal for R.C.C. work like raft, grillages, strips, foundations and footings of R.C.C.columns and steel stanchions including bailing-out water manually, including centering formwork of plywood / steel, compaction, covering newly laid concrete by gunny bag, plastic or tarpaulin, finishing the formed surface with cement mortar 1:3 of sufficient minimum thickness to give a smooth and even surface or roughening if special finish is to be provided and curing etc complete. (Excluding reinforcement) The cement mortar 1:3 plaster is considered for rendering uneven and honeycombed surface only. (Wooden planks / shuttering will not be allowed) Spec.No.:Bd.F.2 Page No. 298 /IS 456 (1978) | 7630.31 | Cubic Metre | 325356.42 |
| 19.83 | 9 | Providing and laying Cast in situ/Ready Mix cement concrete M-25 of trap / granite /quartzite/ gneiss metal for R.C.C. columns as per detailed designs and drawing or as directed including steel centering, formwork, cover blocks, laying/pumping, compaction finishing the formed surfaces with cement mortar 1:3 of sufficient minimum thickness to give a smooth and even surface or roughening if special finish is to be provided and curing etc. complete,(Excluding reinforcement and structural steel).with fully automatic micro processor based PLC with SCADA enabled reversible Drum Type mixer/ concrete Batch mix plant (Pan mixer) etc. complete. With fine aggregate (Natural Sand / Crushed sand VSI Grade finely washed etc) | 14310.31 | Cubic Metre | 283773.45 |
| 28.84 | 10 | Providing and laying Cast in situ/Ready Mix cement concrete M-25 of trap / granite /quartzite/ gneiss metal for R.C.C. beams and lintels as per detailed designs and drawings or as directed including steel centering, formwork, cover blocks, laying/pumping, compaction and roughening the surface if special finish is to be provided and curing etc. complete. (Excluding reinforcement and structural steel). with fully automatic micro processor based PLC with SCADA enabled reversible Drum Type mixer/ concrete Batch mix plant (Pan mixer) etc. complete. With fine aggregate (Natural Sand / Crushed sand VSI Grade finely washed etc) | 12783.83 | Cubic Metre | 368685.66 |



| Quantity | I.No | Item of work | Rate | unit | Amount |
|----------|------|--|----------|--------------|-----------|
| 1.61 | 11 | Providing and laying Cast in situ/Ready Mix cement concrete in M-20 of trap / granite/gneiss/ quartzite metal for R.C.C. fins of required thickness in positions as shown on the drawings or as directed by Engineer -in-charge including steel centering, plywood / steel form work, steel props, laying/ pumping, compaction ,finishing uneven and honey combed surface with C.M.1:3 of sufficient minimum thickness to give a smooth and even surface or roughening the surface if special finish is to be provided and curing etc. complete. (Excluding reinforcement, including cover block) Newly laid concrete shall be covered by gunny bag, plastic, tarpaulin etc. with fully automatic microprocess or based PLC with SCADA enable reversible Drum Type mixer/ concrete Batchmix plant (Panmixer) etc. complete. With fine aggregate (Crushed sand VSI Grade) | 17930.22 | Cubic Metre | 28867.65 |
| 2.75 | 12 | Providing and casting in situ cement concrete of M-25 grade of trap granite / quartzite / gneiss metal for R.C.C. slabs and landings as per detailed designs and drawings or as directed including fixing plastic cover block of required size at 27 Nos in per 10 Sqm to reinforcement to give a clear cover of 15mm in RCC slabs, fixing fan hook box of 100mm diameter PVC or MS material with required depth with holes or notches as required, bottom with 12mm diameter M.S. bar bend to shape with hooked ends for fan hook and painting to exposed surface, centering, formwork of steel, compaction, covering newly laid concrete by gunny bag, plastic or tarpaulin, finishing the formed surface with cement mortar 1:3 of sufficient minimum thickness to give a smooth and even surface or roughening if special finish is to be provided and curing etc. complete. (Excluding reinforcement. The cement mortar 1:3 plaster is considered for rendering uneven and honeycombed surface only. Wooden planks / shuttering will not be allowed). Bd.F.8 Page No. 302 / IS 456:2000 | 14459.31 | Cubic Metre | 39763.10 |
| 7.24 | 13 | Providing and fixing in position TMT - FE - 500 bar reinforcement of various diameters for R.C.C. pile caps, footings, foundations, slabs, beams columns, canopies, staircase, newels, chajjas, lintels pardis, copings, fins, arches etc. as per detailed designs, drawings and schedules. including cutting, bending, hooking the bars, binding with wires or tack welding and supporting as required complete. | 89703.00 | Metric Tonne | 649449.72 |
| 58.68 | 14 | Providing dry rubble stone pitching 23cm (about 9) thick including all material, quarry spalls, labour etc.complete. | 693.83 | Square Metre | 40713.94 |

| Quantity | I.No | Item of work | Rate | unit | Amount |
|----------|------|--|---------|--------------|-----------|
| 9.88 | 15 | Providing Brick masonry in cement mortal 1:6 using second Class Burnt Bricks in foundation and plinth of inner walls/ in plinth of external walls including bailing out water manually, striking joints on unexposed faces ,watering and scaffolding complete Bd. G. 1, Page No.313, | 7836.71 | Cubic Metre | 77426.69 |
| 106.54 | 16 | Providing second class Burnt Brick masonry with conventional/ I.S. type bricks in cement mortar 1:6 in superstructure including striking joints, raking out joints, watering and scaffolding etc. Complete | 8075.71 | Cubic Metre | 860386.14 |
| 1347.68 | 17 | Providing sand faced plaster externally in cement mortar using approved screened sand, in all positions including base coat of 15 mm thick in cement mortar 1:4 using waterproofing compound at 1 kg per cement bag curing the same for not less than 2 days and keeping the surface of the base coat rough to receive the sand faced treatment 6 to 8 mm thick in cement mortar 1:4 finishing the surface by taking out grains and curing for fourteen days scaffolding etc.complete. | 647.89 | Square Metre | 873148.40 |
| 37.84 | 18 | Providing and fixing steel ventilat or fully glazed partly fixed as per detailed drawing with hot dip zinc coating including fabricating glazing with plain/ obscured glass pans 5mm thick and approved type quality and iron oxidized fixtures and fastening with guards quare bars 12mm 10cmc /cand oil painting 2coats etc. complete. | 4827.00 | Square Metre | 182653.68 |
| 1347.68 | 19 | Providing and applying white-wash in one coat on old/ new plastered or masonry surfaces and asbestos cement sheets including scaffolding and preparing the surface by brushing and brooming down etc. complete. | 8.00 | Square Metre | 10781.44 |
| 1347.68 | 20 | Providing and applying plastic emulsion paint of approved quality, colour and shade to old and new surfaces in two coats including scaffolding, preparing the surface. (excluding the primer coat) etc. complete. | 80.00 | Square Metre | 107814.40 |



| Quantity | I.No | Item of work | Rate | unit | Amount |
|----------|------|---|-----------|--------------|------------|
| 25.20 | 21 | Providing and fixing rolling shutter fabricated from steel at hsofminimum thickness 0.9mm with lock plate of 3.15 mm thickness reinforced with 35x35x5mm angle section fitted with sliding bolts and handles for both sides, deep M.S.channel section of depth and thickness not less than 65mm and 3.15mm respectively with hold fastarr angements, M.S.Bracket plate 300x300x3.15mm minimum size and shape with square bar, suspension shaft of minimum 32mm diameter, hood cover of M.S. sheet not less than 0.9mm thickness and of any size atopand safety device sincluding mechanical gear operation arrangement consisting of worm gear wheels and worms of high grade castir on or mild steel and one coat of redlead primer etc. complete.(I.S.62481979) (Without mechanical gear) | 4829.00 | Square Metre | 121690.80 |
| 549.76 | 22 | Providing and laying in situ cement concrete M20 with tremix treatment for 100 mm thickness for flooring with groove cutting of 4mm wide and 20mm deep with necessary refilling with bitumen etc. complete. | 829.84 | Square Metre | 456212.84 |
| 19.08 | 23 | Providing structural steel work in trusses, other similar trussed purlins and members with all bracing, gusset plates etc. as per detailed designs and drawings or as directed including cutting, fabricating, hoisting, erecting fixing in position, Making riveted/ bolted/ welded connection and one coat of anti corrosive paint and over it 2 coats of oil painting approved quality and shade etc. complete. | 119459.00 | Metric Tonne | 2279277.72 |
| 759.58 | 24 | Providing and fixing colour coated Zinalume (R) AZ 150 (min150 gms /sq.mt. total on each side) profiled sheets for roofing. The feed materialis manufactured out of nominal 0.45mm Base Metal Thickness (BMT) (0.5mm TCT), Hi-strength steel with min. 550 MP a yield strength, metallic hot dip coated with Aluminium-Zinc alloy (55% aluminium 43.4% zinc 1.6% silicon) with COLOR BOND (R) steel quality super durable polyester paint coat (with in organic pigment). The paint shall have a total coating thickness of nominal 35um, comprising of nominal 25 um exterior coat on top surface and nominal 10um reverse coat on back surface. Profile sheet shall have nom. 950-1050 mm effective cover width and nominal 25-30 mm deep ribs with subtles quare flutingin the five panat nominal 180-250 mm center-to-center. The endrib shall be designed for anti-capillary groove. and return leg. The feed material should have coil manufacturers product details marked a regular interval. Including fasteners with min. fastened with min. 25um Zinc-Tinalloy coated, Hexhead, self-drilling screw etc. complete. (weight of profile 4.52Kilogram./Square Metre.) | 1173.00 | Square Metre | 890987.34 |



(167)

| Quantity | I.No | Item of work | Rate | unit | Amount |
|----------|------|---|-------------------|----------------|------------------------|
| 6.00 | 25 | Turbo ventilator 24" MATERIAL RATES FOR SSR For Year 2021-22,Page no. 374, Building (Bd-R : Roofing and ceiling) | 9702.00 | No. | 58212.00 |
| 20.70 | 26 | Providing and fixing UPVC Roof made up of 3 layers roofing material of thickness 2mm having width of 1130mm and of required Length having Tensile strength not less than 330Kilo gram/ cm ² , including fastening with self drilling screw having washers made of stainless steel etc. complete. | 1594.00 | Square Metre | 32995.80 |
| | | | | Total Rs. | 8662597.55 |
| 205.68 | 27 | Royalty Charges for sand | Part A) 237.37 | Say Rs. Cum | 8662598.00 48822.26 |
| 385.89 | | Royalty Charges for Rubble and HM | 216.18 | Cum | 83421.70 |
| 1.00 | 28 | Material Testing Charges | 15025.00 | | 15025.00 |
| | | | | Total Rs. | 147268.96 |
| | | | Part B) | Say Rs. | 147269.00 |

Ghaskar
Chartered Engineer

Gaurav Rajendra Bhaskar
B.E.(Civil) A.M.I.E.
Chartered Engineer
AM3023322

Badhe
Consulting Engineer

SAI CONSULTANT
Consulting Civil Engineer
Rahuri, Dist. Ahmednagar



(168)

Name Of Work :- Proposed Construction of 1000MT Warehouse Unit Building In G.no.138 Paiki, For Surya Tej Farmers Producer Co. Ltd., At- Saknewadi, Tal:-Osmanabad, Dist:- Osmanabad(MH)

MEASUREMENT SHEET

I.No.

- 1 Excavation for foundation in earth, soil of all types, sand, gravel and soft murum, including removing the excavated material up to a distance of 50 m.beyond the building area & stacking and spreading as directed, dewatering, preparing the bed for the foundation and necessary back filling, ramming, watering Including shoring and strutting etc. complete. (LIFT UPTO 1.5 M.) By Mechanical Means

| | | | | | | | | | | |
|-------------------------|----|---|------|---|------|---|------|---|------------------|---------------------|
| For RCC Coloumn Type C1 | 20 | x | 1.80 | x | 1.80 | x | 1.20 | = | 77.76 | Cum |
| For RCC Coloumn Type C2 | 6 | x | 1.60 | x | 1.60 | x | 1.20 | = | 18.43 | |
| For RCC Coloumn Type C4 | 4 | x | 1.60 | x | 1.60 | x | 1.20 | = | 12.29 | |
| For RCC Coloumn Type C5 | 8 | x | 1.50 | x | 1.50 | x | 1.20 | = | 21.60 | |
| | | | | | | | | | Total Qty | = 130.08 Cum |

- 2 Excavation for foundation in Hard murum in cluding removing the excavated material upto adistance of 50 metres beyond the building area and stacking and spreading as directed, dewatering, preparing the bed for the foundation and necessary backfilling, ramming, watering including shoring and strutting etc. complete. (Lift from 1.5 to 3.0m.) By Mechanical Means

| | | | | | | | | | | |
|-------------------------|----|---|------|---|------|---|------|---|------------------|--------------------|
| For RCC Coloumn Type C1 | 20 | x | 1.80 | x | 1.80 | x | 0.60 | = | 38.88 | Cum |
| For RCC Coloumn Type C2 | 6 | x | 1.60 | x | 1.60 | x | 0.60 | = | 9.22 | |
| For RCC Coloumn Type C4 | 4 | x | 1.60 | x | 1.60 | x | 0.60 | = | 6.14 | |
| For RCC Coloumn Type C5 | 8 | x | 1.50 | x | 1.50 | x | 0.60 | = | 10.80 | |
| | | | | | | | | | Total Qty | = 65.04 Cum |

- 3 Providing dry trap/ granite/ quartzite/ gneiss rubble stone soiling 15 cm to 20 cm thick including hand packing and compacting complete. Spec.No. : Bd.A.12 Page No. 264 ;

| | | | | | | | | | | |
|-------------------------|----|---|-------|---|-------|---|------|---|------------------|---------------------|
| For RCC Coloumn Type C1 | 20 | x | 1.80 | x | 1.80 | x | 0.23 | = | 14.90 | Cum |
| For RCC Coloumn Type C2 | 6 | x | 1.60 | x | 1.60 | x | 0.23 | = | 3.53 | |
| For RCC Coloumn Type C4 | 4 | x | 1.60 | x | 1.60 | x | 0.23 | = | 2.36 | |
| For RCC Coloumn Type C5 | 8 | x | 1.50 | x | 1.50 | x | 0.23 | = | 4.14 | |
| Ware House Plinth | 1 | x | 35.10 | x | 15.00 | x | 0.23 | = | 121.10 | |
| | | | | | | | | | Total Qty | = 146.03 Cum |

- 4 Filling in plinth and floors with approved excavated material in 15cm. to 20cm. layers including watering and compacting etc. complete.

| | | | | | | | | | | |
|-----------------------------|--|--|--|--|--|--|--|---|------------------|---------------------|
| Qty As per Exavated Quatity | | | | | | | | = | 195.12 | cum |
| Item no.1 & 2 | | | | | | | | | | |
| | | | | | | | | | Total Qty | = 195.12 cum |

- 5 Filling in plinth and floors with contractors material/ brought from outside and approved by Engineer in charge in layers of 15 cm to 20 cm including watering and compaction etc.complete.

| | | | | | | | | | | |
|-----------------------------|---|---|-------|---|-------|---|------|---|------------------|---------------------|
| Ware House Plinth | 1 | x | 33.90 | x | 13.80 | x | 0.45 | = | 210.52 | cum |
| Deduction Internal side WH. | 2 | x | 35.10 | x | 0.60 | x | 0.50 | = | 21.06 | |
| Periphery Rubble fillig | 2 | x | 13.80 | x | 0.60 | x | 0.50 | = | 8.28 | |
| | | | | | | | | | 29.34 | |
| | | | | | | | | | Total Qty | = 181.18 cum |



(169)

- 6 Providing and filling in the foundation with sand of approved quality including watering, compacting etc. complete. (To be executed with prior approval of Superintending Engineer)

| | | | | | | | | | | |
|---|---|---|-------|---|-------|---|------|---|----------|------------------|
| Deduction Internal side WH. Periphery Rubble fillig | 2 | x | 35.10 | x | 0.60 | x | 0.05 | = | 2.11 | cum |
| | 2 | x | 13.80 | x | 0.60 | x | 0.05 | = | 0.83 | |
| Ware House Flooring Soling | 1 | x | 35.10 | x | 15.00 | x | 0.05 | = | 26.33 | |
| Total Qty | | | | | | | | | = | 29.27 cum |

- 7 Providing and laying Cast in situ/ Ready Mix cement concrete in M-10 of trap/granite/quartzite/ gneiss metal for foundation and bedding including bailing out water, Steel centering, formwork, laying/pumping, compacting, roughening them if special finish is to be provided, finishing if required and curing complete ,with fully automatic microprocess or base dPLCwith SCADA enable dreversible Drum Type mixer/ concrete Batch mix plant (Panmixer) etc.complete. With fine aggregate (Crushed sand VSI Grade)

| | | | | | | | | | | |
|-------------------------|----|---|-------|---|-------|---|------|---|----------|------------------|
| For RCC Coloumn Type C1 | 20 | x | 1.80 | x | 1.80 | x | 0.10 | = | 6.48 | cum |
| For RCC Coloumn Type C2 | 6 | x | 1.60 | x | 1.60 | x | 0.10 | = | 1.54 | |
| For RCC Coloumn Type C4 | 4 | x | 1.60 | x | 1.60 | x | 0.08 | = | 0.82 | |
| For RCC Coloumn Type C5 | 8 | x | 1.50 | x | 1.50 | x | 0.08 | = | 1.44 | |
| Ware House Plinth | 1 | x | 35.56 | x | 15.46 | x | 0.10 | = | 54.98 | cum |
| Total Qty | | | | | | | | | = | 65.26 cum |

- 8 Providing and laying in situ cement concrete of M-25 grade of trap / granite/quartzite/gneiss metal for R.C.C. work like raft, grillages, strips, foundations and footings of R.C.C.columns and steel stanchions including bailing-out water manually, including centering formwork of plywood / steel, compaction, covering newly laid concrete by gunny bag, plastic or tarpaulin, finishing the formed surface with cement mortar 1:3 of sufficient minimum thickness to give a smooth and even surface or roughening if special finish is to be provided and curing etc complete. (Excluding reinforcement) The cement mortar 1:3 plaster is considered for rendering uneven and honeycombed surface only. (Wooden planks / shuttering will not be allowed) Spec.No.:Bd.F.2 Page No. 298 /IS 456 (1978)

1st Step of Footing

| | | | | | | | | | | |
|-------------------------|----|---|------|---|------|---|------|---|-------|-----|
| For RCC Coloumn Type C1 | 20 | x | 1.50 | x | 1.50 | x | 0.45 | = | 20.25 | cum |
| For RCC Coloumn Type C2 | 6 | x | 1.30 | x | 1.30 | x | 0.45 | = | 4.56 | |
| For RCC Coloumn Type C4 | 4 | x | 1.30 | x | 1.30 | x | 0.45 | = | 3.04 | |
| For RCC Coloumn Type C5 | 8 | x | 1.20 | x | 1.20 | x | 0.38 | = | 4.38 | |

2nd Step of Footing

| | | | | | | | | | | |
|-------------------------|----|---|------|---|------|---|------|---|----------|------------------|
| For RCC Coloumn Type C1 | 20 | x | 1.20 | x | 1.20 | x | 0.23 | = | 6.62 | |
| For RCC Coloumn Type C2 | 6 | x | 1.00 | x | 1.00 | x | 0.23 | = | 1.38 | |
| For RCC Coloumn Type C4 | 4 | x | 1.00 | x | 1.00 | x | 0.23 | = | 0.92 | |
| For RCC Coloumn Type C5 | 8 | x | 0.90 | x | 0.90 | x | 0.23 | = | 1.49 | |
| Total Qty | | | | | | | | | = | 42.64 cum |

- 9 Providing and laying Cast in situ/Ready Mix cement concrete M-25 of trap / granite /quartzite/ gneiss metal for R.C.C. columns as per detailed designs and drawing or as directed including steel centering, formwork cover blocks, laying/pumping, compaction finishing the formed surfaces with cement mortar 1:3 of sufficient minimum thickness to give a smooth and even surface or roughening if special finish is to be provided and curing complete,(Excluding reinforcement and structural steel).with fully automatic micro processor based SCADA enabled reversible Drum Type mixer/ concrete Batch mix plant (Pan mixer) etc. complete. aggregate (Natural Sand / Crushed sand VSI Grade finely washed etc)

| | | | | | | | | | | |
|-------------------------|----|---|------|---|------|---|------|---|-------|-----|
| For RCC Coloumn Type C1 | 20 | x | 0.23 | x | 0.45 | x | 6.09 | = | 12.61 | cum |
| For RCC Coloumn Type C2 | 6 | x | 0.23 | x | 0.45 | x | 6.09 | = | 3.78 | |

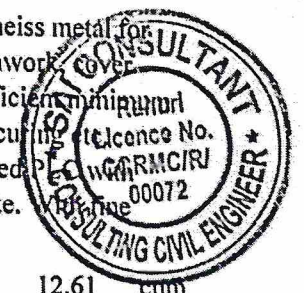

(170)

| | | | | | | | | | |
|-------------------------|---|---|------|---|------|---|------------------|---|------------------|
| For RCC Coloumn Type C4 | 4 | x | 0.23 | x | 0.38 | x | 6.09 | = | 2.13 |
| For RCC Coloumn Type C5 | 8 | x | 0.23 | x | 0.38 | x | 1.87 | = | 1.31 |
| | | | | | | | Total Qty | = | 19.83 cum |

- 10 Providing and laying Cast in situ/Ready Mix cement concrete M-25 of trap / granite /quartzite/ gneiss metal for R.C.C. beams and lintels as per detailed designs and drawings or as directed including steel centering, formwork, cover blocks, laying/pumping, compaction and roughening the surface if special finish is to be provided and curing etc. complete. (Excluding reinforcement and structural steel). with fully automatic micro processor based PLC with SCADA enabled reversible Drum Type mixer/ concrete Batch mix plant (Pan mixer) etc. complete. With fine aggregate (Natural Sand / Crushed sand VSI Grade finely washed etc)

| | | | | | | | | | |
|-----------------------------|----|---|------|---|------|---|------------------|---|------------------|
| Long Wall Ground Beams | 16 | x | 3.72 | x | 0.23 | x | 0.45 | = | 6.16 |
| | 2 | x | 3.44 | x | 0.23 | x | 0.45 | = | 0.71 |
| Short Wall Ground Beams | 8 | x | 3.64 | x | 0.23 | x | 0.45 | = | 3.01 |
| Varandah Plinth Beams Long | 4 | x | 3.51 | x | 0.23 | x | 0.45 | = | 1.45 |
| Varandah Plinth Beams Short | 8 | x | 1.60 | x | 0.23 | x | 0.30 | = | 0.88 |
| Long & Short Wall above V2 | 44 | x | 0.95 | x | 0.23 | x | 0.30 | = | 2.88 |
| Long Wall Lintel Beams | 12 | x | 3.72 | x | 0.23 | x | 0.38 | = | 3.90 |
| Long Wall Beams Above RS | 4 | x | 3.27 | x | 0.23 | x | 0.38 | = | 1.14 |
| Long Wall Floor Beams | 16 | x | 3.72 | x | 0.23 | x | 0.45 | = | 6.16 |
| Short Wall Floor Beams | 8 | x | 3.64 | x | 0.23 | x | 0.38 | = | 2.55 |
| | | | | | | | Total Qty | = | 28.84 cum |

- 11 Providing and laying Cast in situ/Ready Mix cement concrete in M-20 of trap / granite/gneiss/ quartzite metal for R.C.C. fins of required thickness in position as shown on the drawings or as directed by Engineer -in-charge including steel centering, plywood / steel form work, steel props, laying/ pumping, compaction ,finishing uneven and honey combed surface with C.M.1:3 of sufficient minimum thickness to give a smooth and even surface or roughening the surface if special finish is to be provided and curing etc. complete. (Excluding reinforcement, including cover block) Newly laid concrete shall be covered by gunny bag, plastic, tarp aulin etc. with fully automatic microprocess or based PLC with SCADA enable dreversible Drum Type mixer/ concrete Batchmix plant (Panmixer) etc. complete. With fine aggregate (Crushed sand VSI Grade)

| | | | | | | | | | |
|--------------------------------|----|---|------|---|------|---|------------------|---|-----------------|
| Long Wall Ventilators V2 Top | 22 | x | 1.56 | x | 0.45 | x | 0.075 | = | 1.16 |
| Long Wall Ventilators V2 Sides | 44 | x | 0.45 | x | 0.30 | x | 0.075 | = | 0.45 |
| | | | | | | | Total Qty | = | 1.61 cum |

- 12 Providing and casting in situ cement concrete of M-25 grade of trap granite / quartzite / gneiss metal for R.C.C. slabs and landings as per detailed designs and drawings or as directed including fixing plastic cover block of required size at 27 Nos in per 10 Sqm to reinforcement to give a clear cover of 15mm in RCC slabs, fixing fan hook box of 100mm diameter PVC or MS material with required depth with holes or notches as required, bottom with 12mm diameter M.S. bar bend to shape with hooked ends for fan hook and painting to exposed surface, centering, formwork of steel, compaction, covering newly laid concrete by gunny bag, plastic or tarpaulin, finishing the formed surface with cement mortar 1:3 of sufficient minimum thickness to give a smooth and even surface or roughening if special finish is to be provided and curing etc. complete. (Excluding reinforcement. The cement mortar 1:3 plaster is considered for rendering uneven and honeycombed surface only. Wooden planks / shuttering will not be allowed).

Bd.F.8 Page No. 302 / IS 456:2000

| | | | | | | | | | |
|----------------------|---|---|------|---|------|---|------------------|---|-----------------|
| Varandah Plinth Slab | 4 | x | 3.73 | x | 1.60 | x | 0.115 | = | 2.75 |
| | | | | | | | Total Qty | = | 2.75 cum |

- 13 Providing and fixing in position TMT - FE - 500 bar reinforcement of various diameters for R.C.C. pile caps, footings, foundations, slabs, beams columns, canopies, staircase, newels, chajjas, lintels pardis, copings, fins, arches etc. as per detailed designs, drawings and schedules. including cutting, bending, hooking the bars, binding with wires or tack welding and supporting as required complete.

| | | | | | | | |
|-----------------|-------|---|-------|----|---|---------|----|
| For RCC Footing | 42.64 | @ | 70.00 | Kg | = | 2984.80 | Kg |
| For RCC Coloumn | 19.83 | @ | 80.00 | Kg | = | 1586.40 | Kg |
| For RCC Beam | 28.84 | @ | 80.00 | Kg | = | 2307.20 | Kg |



(7)

| | | | | | | | |
|--------------|------|---|-------|------------------|---|----------------|-----------|
| For RCC Fins | 1.61 | @ | 80.00 | Kg | = | 128.80 | Kg |
| For RCC Slab | 2.75 | @ | 85.00 | kg | = | 233.75 | kg |
| | | | | Total Qty | = | 7240.95 | Kg |
| | | | | Say | = | 7.24 | MT |

14 Providing dry rubble stone pitching 23cm (about 9) thick including all material, quarry spalls, labour etc.complete.

| | | | | | | | | | |
|--|---|---|-------|--|---|------|---|------------------|--------------------|
| Long Wall Internal Side Over size Metal in 2 Layers | 2 | x | 35.10 | | x | 0.60 | = | 42.12 | Sqm |
| Short Wall Internal Side Over size Metal in 2 Layers | 2 | x | 13.80 | | x | 0.60 | = | 16.56 | |
| | | | | | | | | Total Qty | = 58.68 Sqm |

15 Providing Brick masonry in cement mortal 1:6 using second Class Burnt Bricks in foundation and plinth of inner walls/ in plinth of external walls including bailing out water manually, striking joints on unexposed faces ,watering and scaffolding complete Bd. G. 1, Page No.313,

| | | | | | | | | | | |
|-------------------------|----|---|------|---|------|---|------|---|------------------|-------------------|
| Long Wall Ground Beams | 16 | x | 3.72 | x | 0.23 | x | 0.45 | = | 6.16 | cum |
| | 2 | x | 3.44 | x | 0.23 | x | 0.45 | = | 0.71 | |
| Short Wall Ground Beams | 8 | x | 3.64 | x | 0.23 | x | 0.45 | = | 3.01 | |
| | | | | | | | | | Total | 9.88 |
| | | | | | | | | | Total Qty | = 9.88 cum |

16 Providing second class Burnt Brick masonry with conventional/ I.S. type bricks in cement mortar 1:6 in superstructure including striking joints, raking out joints, watering and scaffolding etc. Complete

| | | | | | | | | | | |
|---------------------------|----|---|------|---|------|---|------|---|------------------|---------------------|
| Long Wall Superstructure | 16 | x | 3.72 | x | 0.23 | x | 5.20 | = | 71.19 | cum |
| | 2 | x | 3.44 | x | 0.23 | x | 5.20 | = | 8.23 | |
| Short Wall Superstructure | 8 | x | 3.64 | x | 0.23 | x | 5.20 | = | 34.83 | cum |
| Short Gable Wall | 2 | x | 7.50 | x | 0.23 | x | 2.00 | = | 6.90 | |
| | | | | | | | | | Total | = 121.15 |
| Deduction For V2 | 44 | x | 0.60 | x | 0.60 | x | 0.23 | = | 3.64 | |
| Deduction For V1 | 26 | x | 1.41 | x | 0.60 | x | 0.23 | = | 5.06 | |
| Deduction For RS | 2 | x | 2.10 | x | 3.00 | x | 0.23 | = | 2.90 | |
| | 1 | x | 3.30 | x | 3.96 | x | 0.23 | = | 3.01 | |
| | | | | | | | | | Total | = 14.61 |
| | | | | | | | | | Total Qty | = 106.54 cum |

17 Providing sand faced plaster externally in cement mortar using approved screened sand, in all positions including base coat of 15 mm thick in cement mortar 1:4 using waterproofing compound at 1 kg per cement bag curing the same for not less than 2 days and keeping the surface of the base coat rough to receive the sand faced treatment 6 to 8 mm thick in cement mortar 1:4 finishing the surface by taking out grains and curing for fourteen days scaffolding etc.complete.

| | | | | | | | | | |
|---------------------------------|---|---|-------|--|---|------|---|--------|-----|
| Long Wall | 2 | x | 35.56 | | x | 6.48 | = | 460.86 | Sqm |
| Short Wall | 2 | x | 15.46 | | x | 6.48 | = | 200.36 | |
| Long Wall | 2 | x | 35.56 | | x | 5.48 | = | 389.74 | |
| Short Wall | 2 | x | 15.46 | | x | 5.48 | = | 169.44 | |
| Short Span Gable Walls External | 2 | x | 7.50 | | x | 2.00 | = | 30.00 | |
| Short Span Gable Walls Internal | 2 | x | 7.50 | | x | 2.00 | = | 30.00 | |



(192)

| | | | | | | | |
|------------------------------|----|---|------|---|-----------|---|-------------|
| Long Wall Coloumn Offsets C1 | 20 | x | 0.44 | x | 6.48 | = | 57.02 |
| Long Wall Coloumn Offsets C2 | 6 | x | 0.44 | x | 6.48 | = | 17.11 |
| Long Wall Coloumn Offsets C4 | 4 | x | 0.38 | x | 6.48 | = | 9.85 |
| Long Wall Coloumn Offsets C5 | 8 | x | 1.36 | x | 1.20 | = | 13.06 |
| Verandah Slab | 4 | x | 4.19 | x | 1.83 | = | 30.67 |
| Verandah Slab Sides | 8 | x | 1.83 | x | 0.38 | = | 5.56 |
| Verandah Slab Front | 4 | x | 4.19 | x | 0.38 | = | 6.37 |
| V2 Top | 44 | x | 1.56 | x | 0.45 | = | 30.89 |
| V2 Sides | 88 | x | 0.45 | x | 0.60 | = | 23.76 |
| | | | | | Total | | 1474.69 |
| Deduction | | | | | | | |
| Deduction For V2 Both Side | 88 | x | 0.60 | x | 0.60 | | 31.68 |
| Deduction For V1 Both Side | 52 | x | 1.41 | x | 0.60 | | 43.99 |
| Deduction For RS Both Side | 4 | x | 2.10 | x | 3.00 | | 25.20 |
| | 2 | x | 3.30 | x | 3.96 | | 26.14 |
| | | | | | Total | | 127.01 |
| | | | | | Total Qty | = | 1347.68 Sqm |

- 18 Providing and fixing steel ventilat or fully glazed partly fixed as per detailed drawing with hot dip zinc coating including fabricating glazing with plain/ obscured glass pans 5mm thick and approved type quality and iron oxidized fixtures and fastening with guards quare bars 12mm 10cmc /cand oil painting 2coats etc. complete.

| | | | | | | | | |
|----|----|---|------|---|-----------|---|-------|-----|
| V2 | 44 | x | 0.60 | x | 0.60 | = | 15.84 | Sqm |
| V1 | 26 | x | 1.41 | x | 0.60 | | 22.00 | |
| | | | | | Total Qty | = | 37.84 | Sqm |

- 19 Providing and applying white-wash in one coat on old/ new plastered or masonry surfaces and asbestos cement sheets including scaffolding and preparing the surface by brushing and brooming down etc. complete.

| | | | | | | | | |
|-----------------------|--|--|--|--|-----------|---|---------|-----|
| Qty.As per Item no.17 | | | | | | = | 1347.68 | Sqm |
| | | | | | Total Qty | = | 1347.68 | Sqm |

- 20 Providing and applying plastic emulsion paint of approved quality, colour and shade to old and new surfaces in two coats including scaffolding, preparing the surface. (excluding the primer coat) etc. complete.

| | | | | | | | | |
|-----------------------|--|--|--|--|-----------|---|---------|-----|
| Qty.As per Item no.17 | | | | | | = | 1347.68 | Sqm |
| | | | | | Total Qty | = | 1347.68 | Sqm |

- 21 Providing and fixing rolling shutter fabricated from steell at hsofminimum thickness 0.9mm with lock plate of 3.15 mm thickness reinforced with 35x35x5mm angle section fitted with sliding bolts and handles for both sides, deep M.S.channel section of depth and thickness not less than 65mm and 3.15mm respectively with hold fastarr angements, M.S.Brace plate 300x300x3.15mm minimum size and shape with square bar, suspension shaft of minimum 32mm diameter, hood cover of M.S. sheet not less than 0.9mm thickness and of any size attopand safety device sincluding mechanical gear operation arrangement consisting of worm gear wheels and worms of high grade castir on or mild steel and one coat of redlead primer etc. complete.(I.S.62481979) (Without mechanical gear)

| | | | | | | | | |
|------|---|---|------|---|-----------|---|-------|-----|
| RS 1 | 4 | x | 2.10 | x | 3.00 | = | 25.20 | Sqm |
| | | | | | Total Qty | = | 25.20 | 0 |



- 22 Providing and laying in situ cement concrete M20 with tremix treatment for 100 mm thickness for flooring with groove cutting of 4mm wide and 20mm deep with necessary refilling with bitumen etc. complete.

| | | | | | | | | |
|--------------------|---|---|-------|---|-------|---|------------------|---------------------|
| Warehouse Flooring | 1 | x | 35.56 | x | 15.46 | = | 549.76 | Sqm |
| | | | | | | | Total Qty | = 549.76 Sqm |

- 23 Providing structural steel work in trusses, other similar trussed purlins and members with all bracing, gusset plates etc. as per detailed designs and drawings or as directed including cutting, fabricating, hoisting, erecting fixing in position, Making riveted/ bolted/ welded connection and one coat of anti corrosive paint and over it 2 coats of oil painting approved quality and shade etc. complete.

| | | | | | | | | |
|--------------------------------|---|---|---------|---|--|---|------------------|-------------------|
| Total No. of Truss With Purlin | 8 | x | 2210.00 | x | | = | 17680.00 | MT |
| Varandah Canopy | 4 | x | 350.00 | x | | = | 1400.00 | |
| | | | | | | | 19080.00 | |
| | | | | | | | Total Qty | = 19.08 MT |

- 24 Providing and fixing colour coated Zincalume (R) AZ 150 (min 150 gms /sq.mt. total on each side) profiled sheets for roofing. The feed material is manufactured out of nominal 0.45mm Base Metal Thickness (BMT) (0.5mm TCT), Hi-strength steel with min. 550 MP a yield strength, metallic hot dip coated with Aluminium- Zinc alloy (55% aluminium 43.4% zinc 1.6% silicon) with COLOR BOND (R) steel quality super durable polyester paint coat (with in organic pigment). The paint shall have a total coating thickness of nominal 35um, comprising of nominal 25 um exterior coat on top surface and nominal 10um reverse coat on back surface. Profile sheet shall have nom. 950-1050 mm effective cover width and nominal 25-30 mm deep ribs with subtle square fluting in the five panat nominal 180-250 mm center-to-center. The endrib shall be designed for anti-capillary groove. and return leg. The feed material should have coil manufacturers product details marked a regular interval. Including fasteners with min. fastened with min. 25um Zinc-Tin alloy coated, Hexhead, self-drilling screw etc. complete. (weight of profile 4.52 Kilogram /

| | | | | | | | | |
|--|------|---|-------|---|-------|---|------------------|---------------------|
| Roof Slop | 2 | x | 10.50 | x | 35.56 | = | 746.76 | Sqm |
| Verandah | 4 | x | 4.19 | x | 2.00 | = | 33.52 | |
| | | | | | | | Total | 780.28 |
| Deduction For Turbo Ventilator & Sky light Upvc roof | 6.00 | x | 3.00 | x | 1.150 | = | 20.70 | |
| | | | | | | | Total | 20.70 |
| | | | | | | | Total Qty | = 759.58 Rmt |

- 25 Turbo ventilator 24" MATERIAL RATES FOR SSR For Year 2021-22, Page no. 374, Building (Bd-R : Roofing and ceiling)

| | | | | | | | | |
|---------------------------|--|--|--|--|--|---|------------------|-------------------|
| At Roof Level Ventilation | | | | | | = | 6.00 | No. |
| | | | | | | | Total Qty | = 6.00 No. |

- 26 Providing and fixing UPVC Roof made up of 3 layers roofing material of thickness 2mm having width of 1130mm and of required Length having Tensile strength not less than 330Kilo gram/ cm², including fastening with self drilling screw having washers made of stainless steel etc. complete.

| | | | | | | | | |
|--|------|---|------|---|------|---|------------------|--------------------|
| | 6.00 | x | 3.00 | x | 1.15 | = | 20.70 | Sqm |
| | | | | | | | Total Qty | = 20.70 Sqm |

- 27 Royalty Charges

| Material | Qty | | | | | Qty of Material | Cum |
|---|-----|---|-------|---|-------|-----------------|-----------|
| 6 Providing and filling in the foundati | 1 | x | 29.27 | x | 1.000 | = | 29.27 Cum |
| 7 Providing and laying Cast in situ/ R | 1 | x | 65.26 | x | 0.470 | = | 30.67 |

(784)

| | | | | | | | | |
|----|--------------------------------------|---|---|---------|---|-------|---|-------|
| 8 | Providing and laying in situ cement | 1 | x | 42.64 | x | 0.425 | = | 18.12 |
| 9 | Providing and laying Cast in situ/Re | 1 | x | 19.83 | x | 0.425 | = | 8.43 |
| 10 | Providing second class Burnt Brick | 1 | x | 28.84 | x | 0.425 | = | 12.26 |
| 11 | Providing sand faced plaster externa | 1 | x | 1.61 | x | 0.425 | = | 0.68 |
| 12 | Providing and casting in situ cemen | 1 | x | 2.75 | x | 0.425 | = | 1.17 |
| 15 | Providing Brick masonry in cement | 1 | x | 9.88 | x | 0.320 | = | 3.16 |
| 16 | Providing second class Burnt Brick | 1 | x | 106.54 | x | 0.320 | = | 34.09 |
| 17 | Providing sand faced plaster externa | 1 | x | 1347.68 | x | 0.033 | = | 44.47 |
| 22 | Providing and laying in situ cement | 1 | x | 549.76 | x | 0.043 | = | 23.36 |

| | | | | | | | | | | |
|----|--|---|---|---------------|---|-----------|-----------|---|--------|-----|
| | | | | | | Sand | Total Qty | = | 205.68 | Cum |
| 3 | Providing dry trap/ granite/ quartzite | 1 | x | 146.03 | x | 1.00 | | = | 146.03 | |
| 5 | Filling in plinth and floors with con | 1 | x | 181.18 | x | 1.00 | | = | 181.18 | |
| 14 | Providing dry rubble stone pitching | 1 | x | 58.68 | x | 1.00 | | = | 58.68 | |
| | | | | Hm and Rubble | | Total Qty | | = | 385.89 | Cum |

Gurav Rajendra Bhaskar
Chartered Engineer
Gaurav Rajendra Bhaskar
B.E.(Civil) A.M.I.E.
Chartered Engineer
AM3023322

Sai Sankar
Consulting Engineer
SAI CONSULTANT
Consulting Civil Engineer
Rahuri, Dist. Ahmednagar



Name Of Work :- Proposed Construction of 1000MT Warehouse Unit Building In G.no.138 Paiki, For Surya Tej Farmers Producer Co. Ltd., At- Saknewadi, Talai-Osmanabad,
Dist:- Osmanabad(MH)

RATE ANALYSIS AS PER PWD SSR 2022-23 For MAHARASHTRA STATE

| Sr. No. | Description of Item | S.S.R. Page No. & It. No. | Basic Rate | Add extra lead charges for..... | | | | | | Total Lead charges | Gross Rate |
|---------|--|--------------------------------|------------|---------------------------------|--------|-----------|--------|--------------|--------|--------------------|------------|
| | | | | Rubble/Cr. Metal | Sand | Cr. Metal | Murum | Cement/Steel | | | |
| 1 | Excavation for foundation in earth, soil of all types, sand, g | 21.02 | 207.00 | 280.83 | 229.55 | 229.55 | 252.22 | 5.22 | 0.00 | 207.00 | |
| 2 | Excavation for foundation in Hard murum in eluding remo | 21.08 | 284.00 | | | | | | 0.00 | 284.00 | |
| 3 | Providing dry trap/ granite/ quartzite/ gneiss rubble stone s | 21.38 | 1382.00 | 1.00 | 280.83 | | | | 280.83 | 1662.83 | |
| 4 | Filling in plinth and floors with approved excavated materi | 21.36 | 120.00 | | | | | | 0.00 | 120.00 | |
| 5 | Filling in plinth and floors with contractors material/ broug | 21.37 | 795.00 | | | | 1.00 | 252.22 | 252.22 | 1047.22 | |
| 6 | Providing and filling in the foundation with sand of approv | 21.39 | 2160.00 | | 1.00 | 229.55 | | | 229.55 | 2389.55 | |
| 7 | Providing and laying Cast in situ/ Ready Mix cement conc | 24.01 | 5830.00 | | 0.47 | 107.89 | 0.940 | 215.78 | 4.40 | 22.97 | 346.64 |
| 8 | Providing and laying in situ cement concrete of M-25 grad | 25.13 | 7287.00 | | 0.425 | 97.56 | 0.90 | 206.60 | 7.50 | 39.15 | 343.31 |
| 9 | Providing and laying Cast in situ/Ready Mix cement conc | 25.33 | 13967.00 | | 0.425 | 97.56 | 0.90 | 206.60 | 7.50 | 39.15 | 343.31 |
| 10 | Providing and laying Cast in situ/Ready Mix cement conc | 25.52 | 12452.00 | | 0.425 | 97.56 | 0.85 | 195.12 | 7.50 | 39.15 | 331.83 |
| 11 | Providing and laying Cast in situ/Ready Mix cement conc | 26.31 | 17601.00 | | 0.425 | 97.56 | 0.85 | 195.12 | 7.00 | 36.54 | 329.22 |
| 12 | Providing and casting in situ cement concrete of M-25 grad | 25.72 | 14116.00 | | 0.425 | 97.56 | 0.90 | 206.60 | 7.50 | 39.15 | 343.31 |
| 13 | Providing and fixing in position TMT - FE - 500 bar reinfo | 26.33 | 89703.00 | | | | | | 0.00 | | 89703.00 |
| 14 | Providing dry rubble stone pitching 23cm (about 9) thick in | 2.34 | 413.00 | 1.00 | 280.83 | | | | 280.83 | | 693.83 |
| 15 | Providing Brick masonry in cement mortar 1.6 using secon | 27.01 | 7755.00 | | 0.32 | 73.46 | | | 1.58 | 8.25 | 81.71 |
| 16 | Providing second class Burnt Brick masonry with conventi | 27.05 | 7994.00 | | 0.32 | 73.46 | | | 1.58 | 8.25 | 81.71 |
| 17 | Providing sand faced plaster externally in cement mortar us | 32.11 | 639.00 | | 0.033 | 7.58 | | | 0.25 | 1.31 | 8.89 |
| 18 | Providing and fixing steel ventilat or fully glazed partly fix | 39.30 | 4827.00 | | | | | | 0.00 | | 4827.00 |
| 19 | Providing and applying white-wash in one coat on old/ new | 36.02 | 8.00 | | | | | | 0.00 | | 8.00 |
| 20 | Providing and applying plastic emulsion paint of approved | 36.12 | 80.00 | | | | | | 0.00 | | 80.00 |
| 21 | Providing and fixing rolling shutter fabricated from steel a | 39.24 | 4829.00 | | | | | | 0.00 | | 4829.00 |
| 22 | Providing and laying in situ cement concrete M20 with tre | 33.30 | 796.00 | | 0.043 | 9.76 | 0.089 | 20.43 | 0.70 | 3.65 | 33.84 |
| 23 | Providing structural steel work in trusses, other similar trus | 23.04 | 119459.00 | | | | | | 0.00 | | 119459.00 |
| 24 | Providing and fixing colour coated Zincalume (R) AZ 150 | 38.34 | 1173.00 | | | | | | 0.00 | | 1173.00 |
| 25 | Turbo ventilator 24" MATERIAL RATES FOR SSR For Y | SSR 22-23,Page no. 374 I.no.42 | 9702.00 | | | | | | 0.00 | | 9702.00 |
| 26 | Providing and fixing UPVC Roof made up of 3 layers roofi | 38.37 | 1594.00 | | | | | | 0.00 | | 1594.00 |
| 27 | Royalty Charges for Rubble and HM | | 216.18 | | | | | | 0.00 | | 216.18 |

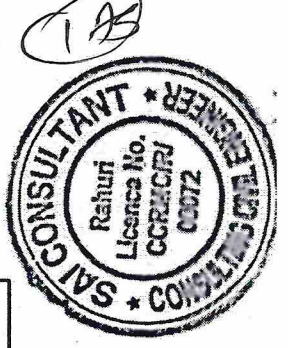

Sadha
Consulting Engineer
SAI CONSULTANT
Consulting Civil Engineer
Rahuri, Dist. Ahmednagar

Chhabras
Chartered Engineer
Gaurav Rajendra Bhaskar
B.E.(Civil) A.M.I.E.
Chartered Engineer
AM3023322

176

Name Of Work :- Proposed Construction of 1000MT Warehouse Unit Building In G.no.138 Paiki, For Surya Tej Farmers Producer Co. ltd., At- Saknewadi, Tal:-Osmanabad, Dist:- Osmanabad(MH)

Appendix - I
Lead Chart

| Sr. No. | Description | Rubble | Murum | Crush metal | Crush metal 40 mm above | Crush Sand | Cement | Steel | Asphalt |
|---------|--|------------|--------|-------------|-------------------------|------------|--------|--------|---------|
| 1 | 2 | 3 | 4 | 4 | 4 | 5 | 6 | 7 | 8 |
| | Source | Restricted | Local | Restricted | Restricted | Restricted | Local | Local | |
| 1 | Average lead as per Quarry chart in km | 3.00 | 5.00 | 3.00 | 3.00 | 3.00 | 1.00 | 1.00 | |
| 2 | Lead charges | 280.83 | 252.22 | 229.55 | 219.98 | 229.55 | 104.39 | 104.39 | |
| 4 | Extra lead charges | 280.83 | 252.22 | 229.55 | 219.98 | 229.55 | 104.39 | 104.39 | |
| 5 | Extra lead charges per bag of cement | | | | | | 5.22 | | |

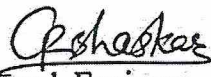
Chartered Engineer
Gaurav Rajendra Bhaskar
B.E.(Civil) A.M.I.E.
Chartered Engineer
AM3023322

Consulting Engineer
SAI CONSULTANT
Consulting Civil Engineer
Rahuri, Dist. Ahmednagar



Name Of Work :- Proposed Construction of 1000MT Warehouse Unit Building In G.no.138 Paiki, For Surya Tej Farmers Producer Co. Ltd., At- Saknewadi, Tal:- Osmanabad, Dist:- Osmanabad(MH)

TESTING CHART

| Item | Qty | Soil/HM | Bitumen | Metal | Agg. | Tests | Frequency | Total Test | At Site | At Lab | Rate | Amt |
|--------------|---------------|--------------|--------------|-------|---------------|--|-----------|------------|----------|----------|----------------|-----------------|
| Concrete | | | | | | | | | | | | |
| | | Cement | Sand | | Agg | | | | | | | |
| M 10 | 38.20 | 8.40 | 17.95 | | 35.91 | | | | | | | |
| M 20 | 54.98 | 19.24 | 2.34 | | 49.48 | Comp. Strength- Cube | | 9 | 5 | 4 | 690.00 | 2760.00 |
| M 25 | 78.05 | 29.27 | 3.32 | | 70.25 | | | | | | | 0.00 |
| Total | 171.23 | 56.91 | 23.61 | | 155.63 | Crush Metal-Basic Test | | 3 | 2 | 1 | 2600.00 | 2600.00 |
| | | MT | Cum | | Cum | Gradation | | 3 | 2 | 2 | 745.00 | 1490.00 |
| | | | | | | Comboned Flakiness & Elongation of single metal | | 2 | 1 | 1 | 850.00 | 850.00 |
| | | | | | | Cement-Fineness, consistency, Setting time, Compressive strength, Specific Gravity | | 1 | 1 | 1 | 3770.00 | 3770.00 |
| | | | | | | Sand-Fineness Modulus, Silt Content | | 1 | 1 | 1 | 1380.00 | 1380.00 |
| | | | | | | Water Absorption (Set of 5 Bricks), Compressive Strength(Set of 5 Bricks), Efflorescence (Set of 5 Bricks). | | 1 | 1 | 1 | 2175.00 | 2175.00 |
| | | | | | | | | | | | Total | 15025.00 |

G. Bhaskar
Chartered Engineer
Gaurav Rajendra Bhaskar
B.E.(Civil) A.M.I.E.
Chartered Engineer
AM3023322

Rahuri
Consulting Engineer
SAI CONSULTANT
Consulting Civil Engineer
Rahuri, Dist. Ahmednagar

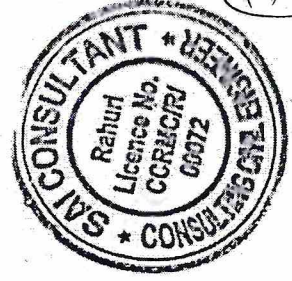

177

Name Of Work :- Proposed Construction of 1000MT Warehouse Unit Building In G.no.138 Paiki, For Surya Tej Farmers Producer Co. Ltd., At- Saknewadi, Tal:-Osmanabad, Dist:- Osmanabad(MH)

Quarry Chart

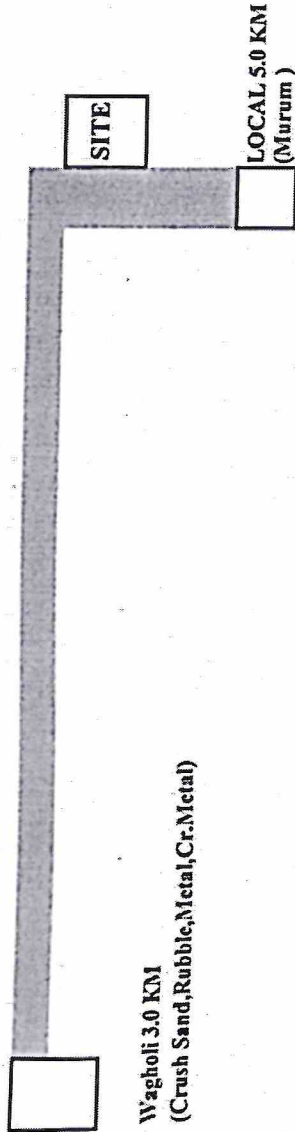

LEAD STATEMENT

| Material | Quarry | Lead in Km. |
|---------------|---------|-------------|
| Rubble | Wagholi | 3.00 |
| Metal | Wagholi | 3.00 |
| Crushed Metal | Wagholi | 3.00 |
| Murum | Local | 5.00 |
| Sand | Wagholi | 3.00 |

CERTIFICATE.

- 1 Certified that the quarries shown on the quarry chart for metal & murum are inspected by me & they are nearest & economical to the work & contain sufficient & good quality material required for the work.
- 2 Certified that lead for quarries shown and accounted in the estimate is as per nearest route.
- 3 Certified that leads considered are found to be correct.

Rajeshkar
Chartered Engineer
Gaurav Rajendra Bhaskar
B.E.(Civil) A.M.I.E.
Chartered Engineer
AM3023322

Sadha
Consulting Engineer
SAI CONSULTANT
Consulting Civil Engineer
Rahuri, Dist. Ahmednagar

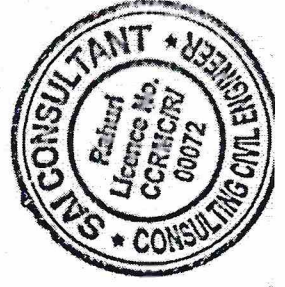

(198)

Name Of Work :- Proposed Construction of 1000MT Warehouse Unit Building In G.no.138 Paiki,
For Surya Tej Farmers Producer Co. Ltd., At- Saknewadi, Tal:-Osmanabad, Dist:-
Osmanabad(MH)

S.W. II - Internal Bituminous roads

ABSTRACT

| Quantity | L.No | Item of work | Rate | unit | Amount |
|----------|------|--|---------|------|-----------|
| 165.75 | 1 | Excavation for road way in earth,soil of all sorts,sand,gravel or soft murum including dressing section to there quired grade,camber and side slope sand conveying the excavated materials with all lifts upto a lead of 50m. and spreading for embankment or stacking as directed. | 119.00 | Cum | 19724.25 |
| 0.00 | 2 | Picking the road surface including sectioning etc. complete (WBM surface.) | 31.00 | Cum | 0.00 |
| 127.08 | 3 | Providing soling using 80 mm size trap metal in 15 cm. layer including filling voids with cum Crushed sand/grit, ramming, watering etc. complete. | 2067.37 | Cum | 262711.04 |
| 256.28 | 4 | Supplying hard murum/ kankar at the road site, including conveying and stacking complete. | 1152.69 | Cum | 295411.39 |
| 256.28 | 5 | Spreading hard murum/ soft murrum/ gravel or kankar for side width complete | 79.00 | Cum | 20246.12 |
| 552.50 | 6 | Compacting the hard murum side width s including laying in layers on each side with vibratory roller including artificial watering etc. | 21.00 | Sqm | 11602.50 |
| 552.50 | 7 | Providing and constructing 75 mm. thick Modified Penetration Macadam (MPM) road surface including all materials, preparing the existing road surface, spreading 40 mm. stone metal layers 100% crusher broken metal with conical crusher plant heating and spraying the bitumen of specified grade @ 2 Kilogram/Square Metre, spreading 12 mm.size chips compacting with three wheel static roller having weight 8 to 10 MT. to achive the desired degree of compaction as per Technical Specification Clause 506 etc. complete. (VG-30 bulk bitumen) | 310.68 | Sqm | 171650.70 |

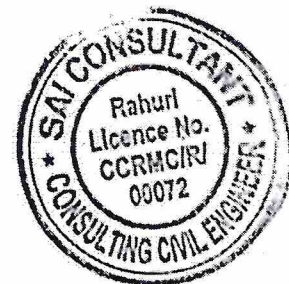

| Quantity | I.No | Item of work | Rate | unit | Amount |
|----------|------|---|---------|-------|-----------|
| 552.50 | 8 | Open Graded Premix Surfacing- Providing and Laying OGC 20 mm thickness composed of 13.2 mm to 5.6 mm aggregates premixed with bituminous binder @ 1.56 Kg/Sqm transported to site with VTS, laid over a previously prepared surface, finished to the required grade, level, alignment, and rolling to achieve the desired compaction but excluding prime / tack and Seal coat. For Bitumen of specified grade--USING drum mix type hot mix plant, Paver and Vibratory roller (Over MPM Surface) (VG-30 bulk Grade 60/70) | 193.46 | Sqm | 106886.65 |
| 1014.80 | 9 | 9 MM SEAL COAT: Providing and laying of Type A 9 mm premix seal coat with HMP of Sqm appropriate capacity crushed stone chipping 6.7 mm size and penetration bitumen of specified grade @ 1.2 kg/Sq.m, preparing existing road surface by mechanical means, spreading chips and rolling, by static roller having weight 8 to 10 MT etc. complete. (VG- | 83.38 | Sqm | 84614.02 |
| | | | | Total | 972846.67 |
| | | | Part A) | Say | 972847.00 |
| 383.36 | 10 | Royalty Charges | 216.00 | Cum | 82805.76 |
| 1.00 | | Material Testing Charges | 8180.00 | | 8180.00 |
| | | | | Total | 90985.76 |
| | | | Part B) | Say | 90986.00 |

Gaurav
Chartered Engineer
Gaurav Rajendra Bhaskar
B.E.(Civil) A.M.I.E.
Chartered Engineer
AM3023322

Sai
Consulting Engineer
SAI CONSULTANT
Consulting Civil Engineer
Rahuri, Dist. Ahmednagar



(18)

Name Of Work :- Proposed Construction of 1000MT Warehouse Unit Building In G.no.138 Paiki, For Surya Tej Farmers Producer Co. Ltd., At- Saknewadi, Tal:-Osmanabad, Dist:- Osmanabad(MH)

S.W. II - Internal Bituminous roads

I.No.

MEASUREMENT SHEET

- 1 Excavation for road way in earth, soil of all sorts, sand, gravel or soft murum including dressing section to there quired grade, camber and side slope sand conveying the excavated materials with all lifts upto a lead of 50m. and spreading for embankment or stacking as directed.
- Road formation
New Road
- | | | | | | | | | | | |
|---------------|---|---|-------|---|------|---|------|-----------|-------|------------|
| Long Side | 1 | x | 35.00 | x | 6.50 | x | 0.30 | = | 68.25 | Cum |
| Entrance Road | 1 | x | 50.00 | x | 6.50 | x | 0.30 | = | 97.50 | Cum |
| | | | | | | | | Total Qty | = | 165.75 Cum |
- 2 Picking the road surface including sectioning etc. complete (WBM surface.)
- Existing Road
- | | | | | | | | | | | |
|------------|---|---|------|---|------|---|------|-----------|------|----------|
| Long Side | 0 | x | 0.00 | x | 0.00 | x | 0.00 | = | 0.00 | Sqm |
| Short Wall | 0 | x | 0.00 | x | 0.00 | x | 0.00 | = | 0.00 | Sqm |
| | | | | | | | | Total Qty | = | 0.00 Sqm |
- 3 Providing soling using 80 mm size trap metal in 15 cm. layer including filling voids with cum Crushed sand/grit, ramming, watering etc. complete.
- | | | | | | | | | | | |
|---------------|---|---|-------|---|------|---|------|-----------|-------|------------|
| Long Side | 1 | x | 35.00 | x | 6.50 | x | 0.23 | = | 52.33 | Cum |
| Entrance Road | 1 | x | 50.00 | x | 6.50 | x | 0.23 | = | 74.75 | Cum |
| | | | | | | | | Total Qty | = | 127.08 Cum |
- 4 Supplying hard murum/ kankar at the road site, including conveying and stacking complete.
- | | | | | | | | | | | |
|-------------------|------|---|-------|---|------|---|------|-----------|--------|------------|
| Long Side | 1 | x | 35.00 | x | 6.50 | x | 0.45 | = | 102.38 | Cum |
| Entrance Road | 1 | x | 50.00 | x | 6.50 | x | 0.45 | = | 146.25 | Cum |
| | | | | | | | | | | |
| For side Shoulder | | | | | | | | | | |
| Long Side | 1.00 | x | 35.00 | x | 0.45 | x | 0.20 | = | 3.15 | Cum |
| Entrance Road | 1.00 | x | 50.00 | x | 0.45 | x | 0.20 | = | 4.50 | Cum |
| | | | | | | | | Total Qty | = | 256.28 Cum |
- 5 Spreading hard murum/ soft murrum/ gravel or kankar for side width complete
Same Qty As Per It No 4
- | | | | | | | | | | | |
|--|--|--|--|--|--|--|--|-----------|---|------------|
| | | | | | | | | Total Qty | = | 256.28 Cum |
|--|--|--|--|--|--|--|--|-----------|---|------------|
- 6 Compacting the hard murum side width s including laying in layers on each side with vibratory roller including artificial watering etc. complete.
- For side Shoulder
- | | | | | | | | | | | |
|---------------|------|---|-------|---|------|--|--|-----------|--------|------------|
| Long Side | 1.00 | x | 35.00 | x | 6.50 | | | = | 227.50 | Sqm |
| Entrance Road | 1.00 | x | 50.00 | x | 6.50 | | | = | 325.00 | Sqm |
| | | | | | | | | Total Qty | = | 552.50 Sqm |
- 7 Providing and constructing 75 mm. thick Modified Penetration Macadam (MPM) road surface including all materials, preparing the existing road surface, spreading 40 mm. stone metal layers 100% crusher broken metal with conical crusher plant heating and spraying the bitumen of specified grade @ 2 Kilogram/Square Metre, spreading 12 mm. size chips compacting with three wheel static roller having weight 8 to 10 MT. to achive the desired degree of compaction as per Technical Specification Clause 506 etc.
- | | | | | | | | | | | |
|---------------|------|---|-------|---|------|--|--|-----------|--------|------------|
| Long Side | 1.00 | x | 35.00 | x | 6.50 | | | = | 227.50 | |
| Entrance Road | 1.00 | x | 50.00 | x | 6.50 | | | = | 325.00 | |
| | | | | | | | | Total Qty | = | 552.50 Sqm |

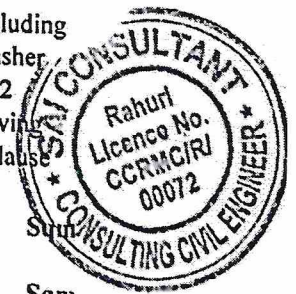

8 Open Graded Premix Surfacing- Providing and Laying OGC 20 mm thickness composed of 13.2 mm to 5.6 mm aggregates premixed with bituminous binder @ 1.56 Kg/Sqm transported to site with VTS, laid over a previously prepared surface, finished to the required grade, level, alignment, and rolling to achieve the desired compaction but excluding prime / tack and Seal coat. For Bitumen of specified grade--USING drum mix type hot mix plant, Paver and Vibratory roller (Over MPM Surface) (VG-30 bulk Grade 60/70)
For Existing & New Road 1.00 x 552.50 = 552.50 Sqm

Total Qty = 552.50 Sqm

9 9 MM SEAL COAT: Providing and laying of Type A 9 mm premix seal coat with HMP of Sqm appropriate capacity crushed stone chipping 6.7 mm size and penetration bitumen of specified grade @ 1.2 kg/Sq.m, preparing existing road surface by mechanical means, spreading chips and rolling, by static roller having weight 8 to 10 MT etc. complete. (VG-

1.00 0 1014.80 = 1014.80 Sqm

Total Qty = 1014.80 Sqm

10 Royalty Charges

| Material | Qty | Consumption | Qty of Material | |
|---|-------------------------|-------------|-----------------|-----|
| 3 Providing soling using 80 mm size trap metz | 127.08 | x 1.00 | = 127.08 | Cum |
| 4 Supplying hard murum/ kankar at the road site, ii | 256.28 | x 1.00 | = 256.28 | |
| | Hm and Rubble Total Qty | | = 383.36 | Cum |
| | | | = 383.36 | Cum |

Gaurav Rajendra Bhaskar

Chartered Engineer

Gaurav Rajendra Bhaskar

B.E.(Civil) A.M.I.E.

Chartered Engineer

AM3023322

Sai

Consulting Engineer

SAI CONSULTANT

Consulting Civil Engineer

Rahuri, Dist. Ahmednagar

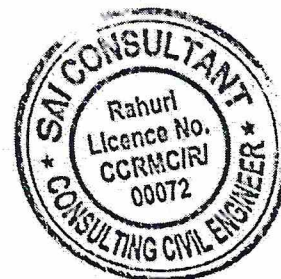

(183)

Name Of Work :- Proposed Construction of 1000MT Warehouse Unit Building In G.no.138 Paiki,
For Surya Tej Farmers Producer Co. Ltd., At- Saknewadi, Tal:-Osmanabad, Dist:- Osmanabad(MH)

S.W. II - Internal Bituminous roads

Rate Analysis for BT Items

Item No.13:- Providing and constructing 75 mm. thick Modified Penetration Macadam (MPM) road surface including all materials, preparing the existing road surface, spreading 40 mm. stone metal layers 100% crusher broken metal with conical crusher plant heating and spraying the bitumen of specified grade @ 2 Kilogram/Square Metre, spreading 12 mm.size chips compacting with three wheel static roller having weight 8 to 10 MT. to achive the desired degree of compaction as per Technical Specification Clause 506 etc.

| | | | | | | | |
|---|-------|-----|---------------|---|-----------|---------------|----------------|
| A) Basic Rate SSR 20222-23 Road Sub Base and Base Course I.No.3.35a | | | | | Rs | 229.00 | Per Sqm |
| <u>Add for asphalt</u> | 46040 | - | 32877 = 13163 | x | 0.002 | Rs | 26.33 Per Sqm |
| <u>Diff.016/09/2022</u> | | | | | | | |
| B) Add.extra lead charges for | | | | | | | |
| A) 40 mm | 0.09 | 70% | | x | 502.27 | Rs. | 31.64 Per Sqm |
| B)40 mm Crush metal | 0.09 | 30% | | x | 393.44 | Rs. | 10.62 Per Sqm |
| C) Crush metal | 0.018 | | | x | 410.55 | Rs | 7.39 Per Sqm |
| D) Bulk asphalt | 0.002 | | | x | 2850.00 | Rs | 5.70 Per Sqm |
| Total Rate | | | | | Rs | 310.68 | Per Sqm |

Item No.15:- Open Graded Premix Surfacing- Providing and Laying OGC 20 mm thickness composed of 13.2 mm to 5.6 mm aggregates premixed with bituminous binder @ 1.56 Kg/Sqm transported to site with VTS, laid over a previously prepared surface, finished to the required grade, level, alignment, and rolling to achieve the desired compaction but excluding prime / tack and Seal coat. For Bitumen of specified grade--USING drum mix type hot mix plant, Paver and Vibratory roller (Over MPM Surface) (VG-30 bulk Grade 60/70)

| | | | | | | | | |
|---|--------|---|---------------|---|-------------------|-----------|---------------|----------------|
| A) Basic Rate SSR 2022-23 Road Surfacing Course I.No.4.11 | | | | | | Rs | 155.00 | Per Sqm |
| <u>Add for asphalt</u> | 46040 | - | 32877 = 13163 | x | 0.00171 | Rs | 22.51 | Per Sqm |
| <u>Diff.016/09/2022</u> | | | | | | | | |
| B) Add.extra lead charges for | | | | | | | | |
| Crush metal | 0.027 | | | x | 410.55 | Rs | 11.08 | Per Sqm |
| Bulk asphalt. (1.46+0.25) | 0.0017 | | | x | 2850.00 | Rs | 4.87 | Per Sqm |
| 1000 | | | | | Total Rate | Rs | 193.46 | Per Sqm |

Item No.16:- 9 MM SEAL COAT: Providing and laying of Type A 9 mm premix seal coat with HMP of Sqm appropriate capacity crushed stone chipping 6.7 mm size and penetration bitumen of specified grade @ 1.2 kg/Sq.m, preparing existing road surface by mechanical means, spreading chips and rolling, by static roller having weight 8 to 10 MT etc. complete. (VG-

| | | | | | | | | |
|---|-------|---|---------------|---|-------------------|-----------|--------------|----------------|
| A) Basic Rate SSR 2022-23 Road Surfacing Course I.No.4.13 | | | | | | Rs | 64.00 | Per Sqm |
| <u>Add for asphalt</u> | 46040 | - | 32877 = 13163 | x | 0.00098 | Rs | 12.90 | Per Sqm |
| <u>Diff.016/09/2022</u> | | | | | | | | |
| B) Add.extra lead charges for | | | | | | | | |
| Crush metal | 0.009 | | | x | 410.55 | Rs | 3.69 | Per Sqm |
| Bulk asphalt. (0.98) | 0.001 | | | x | 2850.00 | Rs | 2.79 | Per Sqm |
| 1000 | | | | | Total Rate | Rs | 83.38 | Per Sqm |

Gaurav
Chartered Engineer

Gaurav Rajendra Bhaskar
B.E.(Civil) A.M.I.E.
Chartered Engineer
AM3023322

Basheer
Consulting Engineer
SAI CONSULTANT
Consulting Civil Engineer
Rahuri, Dist. Ahmednagar



Name Of Work :- Proposed Construction of 1000MT Warehouse Unit Building In G.no.138 Paiki, For Surya Tej Farmers Producer Co. Ltd., At- Saknewadi,
Tal:-Osmanabad, Dist:- Osmanabad(MH)

S.W. II - Internal Bituminous roads

RATE ANALYSIS AS PER FWD SSR 2022-23

| Sr. No. | Description of Item | D.S.R. Page No. & It. No. | Basic Rate | Add extra lead charges for..... | | | | | | Total Lead charges | Gross Rate |
|---------|--|---------------------------|------------|---------------------------------|-----------------------|-----------------------|-----------------------|--------------|-------|--------------------|------------|
| | | | | Rubble/Cr. Metal | Sand | Cr. Metal | Murum | Cement/Steel | | | |
| 1 | Excavation for road way in earth, soil of all | 2.11 | 119.00 | 280.83/229.55 | 229.55/M ³ | 229.55/M ³ | 252.22/M ³ | 5.22/M.T. | 0.00 | 119.00 | |
| 2 | Picking the road surface including sectioning etc. | 2.32 | 31.00 | | | | | | 0.00 | 31.00 | |
| 3 | Providing soling using 80 mm size trap metal in 15 | 2.140 | 1454.00 | 1.21 | | 0.27 | 61.98 | 0.08 | 20.18 | 1813.92 | |
| 4 | Supplying hard murum/ kankar at the road site, including | 2.29a | 598.00 | | 0.47 | 107.89 | 0.90 | 206.60 | 4.40 | 935.46 | |
| 5 | Spreading hard murum/ soft murum/ gravel or kankar for | 2.30 | 79.00 | | | | | | 0.00 | 79.00 | |
| 6 | Compacting the hard murum side width s including laying | 2.31 | 21.00 | | | | | | 0.00 | 21.00 | |
| 7 | Providing and constructing 75 mm. thick Modified Per | 3.35a | 310.68 | | | | | | 0.00 | 310.68 | |
| 8 | Open Graded Premix Surfacing- Providing and Laying | 4.11 | 193.46 | | | | | | 0.00 | 193.46 | |
| 9 | 9 MM SEAL COAT: Providing and laying of Type A 9 | 4.13 | 83.38 | | | | | | 0.00 | 83.38 | |
| 10 | Royalty Charges | | 216.00 | | | | | | 0.00 | 216.00 | |

Gaurav Rajendra Bhaskar
Chartered Engineer
Gaurav Rajendra Bhaskar
B.E.(Civil) A.M.I.E.
Chartered Engineer
AM3023322

Zaheer
Consulting Engineer
SAI CONSULTANT
Consulting Civil Engineer
Rahuri, Dist. Ahmednagar

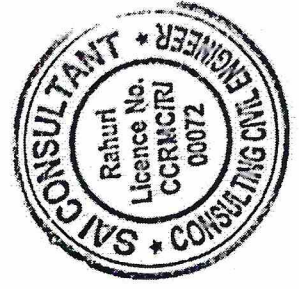

184

Name Of Work :- Proposed Construction of 1000MT Warehouse Unit Building In G.no.138 Paiki, For Surya Tej Farmers Producer Co. Ltd., At- Saknewadi, Tal:- Osmanabad, Dist:- Osmanabad(MH)

S.W. II - Internal Bituminous roads

TESTING CHART

| Item | Qty | Soil/HM | Bitumen | Metal | Agg. | Tests | Frequency | Total Test | At Site | At Lab | Rate | Amt |
|-----------------|---------|---------|---------|-------|-------|--|-----------|------------|---------|--------|---------|---------|
| 75 mm MPM | 1014.75 | | 2.08 | 42.62 | 33.49 | Gradation | 1/100 Cum | 1 | 1 | 1 | 690.00 | 690.00 |
| Total | 1014.75 | | 2.08 | 42.62 | 33.49 | Combined Flakiness & Elongation of single | 1/350 Cum | 0 | 0 | 1 | 850.00 | 850.00 |
| Carpet Sealcoat | 1014.80 | | 2.73 | | 36.53 | Binder Content | 2/day | 2 | 1 | 1 | 1595.00 | 1595.00 |
| Total | | | 4.81 | 42.62 | 70.02 | Penetration, Softening Point, Flash & Fire Point, Specific Gravity | 2/day | 2 | 1 | 1 | 3135.00 | 3135.00 |
| | | | | | | Viscosity | 2/day | 2 | 1 | 1 | 1910.00 | 1910.00 |
| | | | | | | | | 2 | | | Total | 8180.00 |

Gaurav Rajendra Bhaskar
Chartered Engineer
Gaurav Rajendra Bhaskar
B.E.(Civil) A.M.I.E.
Chartered Engineer
AM3023322

Rahuri
Consulting Engineer
SAI CONSULTANT
Consulting Civil Engineer
Rahuri, Dist. Ahmednagar

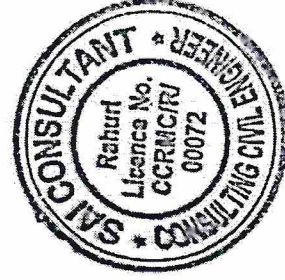

185

Name Of Work :- Proposed Construction of 1000MT Warehouse Unit Building In G.no.138 Paiki,
For Surya Tej Farmers Producer Co. Ltd., At- Saknewadi, Tal:-Osmanabad, Dist:- Osmanabad(MH)

Sub Work No:-III Electrification

ABSTRACT

| Quantity | I.No | Item of work | Rate | unit | Amount |
|----------|------|---|---------|---------------|---------|
| 20.00 | 1 | Supplying, erecting & terminating FR XLPE insulated, galvanised steel formed wire armoured (strip) cable 1100 V, 3 core 6 sq. mm. aluminium conductor complete erected with glands & lugs, on wall/ trusses/pole or laid in provided trench/ pipe as per specification no. CB-LT/AL 7-1-9 | 137.00 | Running Meter | 2740.00 |
| 10.00 | 2 | Making trench in soft soil having 0.75 m depth and minimum 0.3 m width for laying provided cables up to voltage level of 1.1kV complete As per specification No. CW-EXN-CTR 16-1-1 | 161.00 | Running Meter | 1610.00 |
| 10.00 | 3 | Making trench in Hard murum/Tar road having 0.75 m depth and minimum 0.3mtr width as per IS for laying provided cables up to voltage level 1.1Kv cable complete as per specification No. CW-EXN-CTR 7-2-5 | 199.00 | Running Meter | 1990.00 |
| 80.00 | 4 | Supplying and erecting mains with 3x2.5 sq.mm FRLSH copper PVC insulated wire laid in provided conduit/trunking/inside pole/Bus bars or any other places as per specification No: WG-MA/BW 5-12-1 | 93.00 | Running Meter | 7440.00 |
| 4.00 | 5 | Supplying & erecting CRCA sheet metal enclosures of 1.2mm thickness with 10A, 2 pin plug & earth socket and 10A, 3 pin plug top with 10A single pole MCB having rated short - circuit breaking capacity (Icn) 10kA complete erected on angle iron / GI frame. 5-4-10 | 800.00 | Number | 3200.00 |
| 4.00 | 6 | Point wiring for light/fan/bell in 20 mm FRLS grade HMS PVC conduit with 1.5 sq.mm (2+1E) FRLSH grade copper wire with flush type switch and required accessories as per specification No: WG-PW/SW 1-7-3 | 1929.00 | Number | 7716.00 |
| 4.00 | 7 | Supplying & erecting 10-12W, 230V integral type LED Lamp suitable for B-22 /E-27 base. 2-8-11 | 230.00 | Number | 920.00 |



(88)

| Quantity | I.No | Item of work | Rate | unit | Amount |
|----------|------|--|---------|--------------|---------|
| 4.00 | 8 | Supplying and erecting integrated LED street light fitting 18 to 22W IP65 & IK08 class having single piece pressure die-cast aluminium housing, having system lumens output of Min. 1800 Lumens, min. efficacy of 100 lumen/W, CRI>70, CCT upto 6500K, THD<10%, p.f. >0.95, operating range of 140- 270V, inbuilt surge protection of 10 kV, Life class of 50,000 Hrs. at L70B50, including driver complete with 3 Years warranty as per specification No FGODF/ FLS2. 2-4-1 | 1929.00 | Number | 7716.00 |
| 4.00 | 9 | Supplying and erecting Street light bracket made from 40 mm. dia 'B' class G.I. Pipe, 0.6m. in length along with pole cap of 300 mm length and 80 mm dia duly welded with provided leads as per specification no. FG-BKT/BPC 2-7-2 | 736.00 | Number | 2944.00 |
| 1.00 | 10 | Providing earthing with galvanized iron earth plate size 60 x 60 x 0.6 cm complete with all materials, testing & recording the results as per specification no. EA-EP 9-1-1 | 4714.00 | Number | 4714.00 |
| 1.00 | 11 | Providing pipe type earthing with 40mm. dia. G.I. pipe or 20 mm dia. G.I. Rod complete with all materials testing and recording the results as per specification no. EA-EP 9-1-4 | 1500.00 | Number | 1500.00 |
| 1.00 | 12 | Supplying, erecting & marking DPMCB 6A to 32A, C-series with rated short -circuit breaking capacity (Icn) 10kA in provided distribution board as per specification no. SW-SWR/MCB 5-3-6 | 535.00 | Number | 535.00 |
| 1.00 | 13 | Supplying, erecting & marking SPMCB 6A to 32A, B-series with rated short - circuit breaking capacity (Icn) 10kA in provided distribution board as per specification no. SW-SWR/MCB 5-3-3 | 173.00 | Number | 173.00 |
| 1.00 | 14 | Supplying and erecting GI sheet 1.6 mm (16 SWG) having zinc coating of 350 microns with galvanization process compliance to IS 2629:1985 to be used for fabrication of boxes panel boards etc. including cutting, bending, drilling, welding, riveting etc. and painting with one coat of red lead paint and 2 coats of enamel paint. 6-1-6 | 2560.00 | Square Metre | 2560.00 |
| 1.00 | 15 | Supplying and erecting marine (Waterproof) plywood 18/19 mm thick fixed to wall or on provided panel board with necessary materials such as screws, wall fasteners, supports, nut bolts etc. complete with compliance to IS 720:2010 6-1-14 | 1471.00 | Square Metre | 1471.00 |



(128)

| Quantity | I.No | Item of work | Rate | unit | Amount |
|----------|------|--|---------|---------------|----------|
| 2.00 | 16 | Supplying & erecting triple pole and neutral distribution board (TPNDB), 3 pole/ 4 pole MCCB as incomer & outgoing SP MCB (12 poles) or TP MCB of 4 ways (12 poles), with door, 1.2mm thickness, surface/flush mounted, on iron/GI frame (vertical busbar type) as per specification no.SW-SWR/MCBDB1 5-4-15 | 6568.00 | Number | 13136.00 |
| 10.00 | 17 | Supplying & erecting G.I. pipe 'A' class 25 mm dia. erected for enclosing XLPE armoured cable on wall/pole as per specification no. CB-CE 7-6-1 | 217.00 | Running Meter | 2170.00 |
| 10.00 | 18 | Supplying & erecting G.I. pipe 'A' class 40 mm dia. erected for enclosing XLPE armoured cable on wall/pole as per specification no. CB-CE 7-6-2 | 337.00 | Running Meter | 3370.00 |
| 6.00 | 19 | Supplying and laying (including excavation of suitable width & depth up to 90 cm) 75 mm outside dia. double wall corrugated pipes (DWC) of HDPE for enclosing cable below ground/road surface, to required depth complete. 7-6-10 | 241.00 | Running Meter | 1446.00 |
| 2.00 | 20 | Supplying & erecting 18 gauge M.S. Box powder coated (4"x4") 3 way for mains connection. MR | 500.00 | Number | 1000.00 |
| 4.00 | 21 | Supplying & erecting single compression type brass cable glands for 3 to 4 core 6 sq mm /2 to 4 core 10 sq mm for XLPE armoured cable as per specification No.CB-GL 7-7-2 | 87.00 | Number | 348.00 |
| 1.00 | 22 | Supplying and erecting Ceiling rose / Batten holder / Slanting holder / hanging cord switch / hanging bell push / pendant holder bakelite base 6A. erected on filled polypropylene board or polished double wooden block/ PVC junction box. 1-5-7 | 39.00 | Number | 39.00 |
| 2.00 | 23 | Point wiring for independent plug in 20 mm metal conduit with 1.5 sq.mm (2+1E) FRLSH grade copper wire, flush type switch, earthing and required accessories as per specification No: WG-PW/SW 1-7-2 | 941.00 | Number | 1882.00 |
| 1.00 | 24 | Wiring for plug on board with Switch socket surface/concealed type, copper wiring and earthing and with modular accessories as per specification No: WGPW/ CW 1-7-26 | 386.00 | Number | 386.00 |
| 2.00 | 25 | Supplying and erecting mains with 2x2.5 sq.mm FRLSH copper PVC insulated wire laid in provided conduit/trunking/inside pole/Bus bars or any other places. as per specification No: WG-MA/BW 1-3-2 | 62.00 | Running Meter | 124.00 |

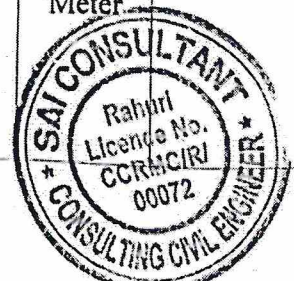

| Quantity | I.No | Item of work | Rate | unit | Amount |
|----------|------|--|---------|---------------|----------|
| 2.00 | 26 | Supplying and erecting mains with 2x4 sq.mm FRLSH copper PVC insulated wire laid in provided conduit/trunking/inside pole/Bus bars or any other places. as per specification No: WG-MA/BW 1-3-3 | 89.00 | Running Meter | 178.00 |
| 1.00 | 27 | Supplying and erecting modular type D.P. switch 32A with indicator, duly erected on provided plate and box with wiring connections complete. 1-6-8 | 210.00 | Number | 210.00 |
| 4.00 | 28 | Supplying, erecting and marking double pole isolator only switch version of miniature circuit breaker of 40A with required wiring connections and lugs etc.in provided distribution board. 5-3-14 | 310.00 | Number | 1240.00 |
| 1.00 | 29 | Supplying & erecting 3W, 230V integral type LED Lamp suitable for B-22 / E- 27 base. 2-8-9 | 126.00 | Number | 126.00 |
| 4.00 | 30 | Supplying and erecting IP65 and IK08 rated UV shielded polycarbonate waterproof and dustproof industrial grade LED fitting (4 feet) max. 36W with high transitivity diffuser with system lumens output of min. 4300 lumens , min. efficacy of 120 lumen/W, CRI>80, CCT upto 6500K, Beam Angle of 120 deg., Ripple<5%, THD<10%, p.f. >0.95, operating range of 120-270V, surge protection of 4 kV, Life class of 50,000 Hrs. at L70B50 , IP20 rated, including driver with auto cutoff & auto restart feature at 325V with end caps on PVC lock/wooden board with 3 years warranty. 2-2-1 | 3396.00 | Number | 13584.00 |
| 1.00 | 31 | Supplying and erecting regular/ standard model ceiling fan of 900 /1050 mm. sweep complete erected in position as per specification no. FG-FN/CF 2-10-2 | 2092.00 | Square Meter | 2092.00 |
| 2.00 | 32 | Supplying and erecting ding dong / electronic musical type call bell with heavy duty coil suitable to operate on 230V A.C. supply erected on olished double wooden block/sunmica block of suitable size. 2-3-13 | 140.00 | Number | 280.00 |
| 2.00 | 33 | Supplying and erecting Street light bracket made from 25 mm. dia 'B' class G.I. Pipe, 0.6m. in length along with pole cap of 300 mm length and 80 mm dia duly welded with provided leads as per specification no. FG-BKT/BPC 2-7-1 | 655.00 | Number | 1310.00 |
| 1.00 | 34 | Supplying & erecting CRCA sheet metal one way enclosures of 1.2mm thickness suitable for DP MCB /TP MCB/FP MCB/RCCB/RCBO complete erected on angle iron/GI frame. 5-4-13 | 400.00 | Number | 400.00 |

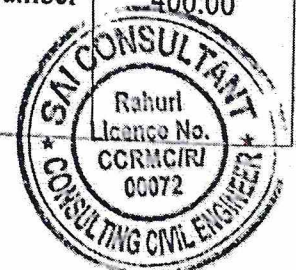

| Quantity | I.No | Item of work | Rate | unit | Amount |
|----------|------|---|---------|-----------|----------|
| 3.00 | 35 | Supplying, erecting and marking four pole isolators only switch version of miniature circuit breakers of 40A in provided distribution board. 5-3-18 | 698.00 | Number | 2094.00 |
| | | | | Total Rs. | 92644.00 |
| | | | Part A) | Say Rs. | 92644.00 |

Gaurav
Chartered Engineer
Gaurav Rajendra Bhaskar
B.E.(Civil) A.M.I.E.
Chartered Engineer
AM3023322

Sai
Consulting Engineer
SAI CONSULTANT
Consulting Civil Engineer
Rahuri, Dist. Ahmednagar



Name Of Work :- Proposed Construction of 1000MT Warehouse Unit Building In G.no.138 Paiki,
For Surya Tej Farmers Producer Co. Ltd., At- Saknewadi, Tal:-Osmanabad, Dist:- Osmanabad(MH)

Sub Work No:-III Electrification

MEASUREMENT SHEET

| Item. No. | Description of Items | NO. | LENTH | BREATH | DEPTH | TOTAL | UNIT | | | | |
|-----------|---|-----|-------|--------|-------|-------|---------------|---------------|---|-------|--|
| 1 | Supplying, erecting & terminating FR XLPE insulated, galvanised steel formed wire armoured (strip) cable 1100 V, 3 core 6 sq. mm. aluminium conductor complete erected with glands & lugs, on wall/ trusses/pole or laid in provided trench/ pipe as per specification no. CB-LT/AL 7-1-9 | | | | | | Running Meter | | | | |
| | Ware House | 1 | x | 1 | x | 20.00 | x | 1 | = | 20.00 | |
| | | | | | | | | Total | | 20.00 | |
| | | | | | | | | Say | | 20.00 | |
| 2 | Making trench in soft soil having 0.75 m depth and minimum 0.3 m width for laying provided cables up to voltage level of 1.1kV complete As per specification No. CW-EXN-CTR 16-1-1 | | | | | | | Running Meter | | | |
| | Ware House | 1 | x | 1 | x | 10.00 | x | 1 | = | 10.00 | |
| | | | | | | | | Total | | 10.00 | |
| | | | | | | | | Say | | 10.00 | |
| 3 | Making trench in Hard murum/Tar road having 0.75 m depth and minimum 0.3mtr width as per IS for laying provided cables up to voltage level 1.1Kv cable complete as per specification No. CW-EXN-CTR 7-2-5 | | | | | | | Number | | | |
| | Ware House | 1 | x | 1 | x | 10.00 | x | 1 | = | 10.00 | |
| | | | | | | | | Total | | 10.00 | |
| | | | | | | | | Say | | 10.00 | |
| 4 | Supplying and erecting mains with 3x2.5 sq.mm FRLSH copper PVC insulated wire laid in provided conduit/trunking/inside pole/Bus bars or any other places as per specification No: WG-MA/BW 5-12-1 | | | | | | | Running Meter | | | |
| | Ware House | 1 | x | 1 | x | 80.00 | x | 1 | = | 80.00 | |
| | | | | | | | | Total | | 80.00 | |
| | | | | | | | | Say | | 80.00 | |
| 5 | Supplying & erecting CRCA sheet metal enclosures of 1.2mm thickness with 10A, 2 pin plug & earth socket and 10A, 3 pin plug top with 10A single pole MCB having rated short - circuit breaking capacity (Icn) 10kA complete erected on angle iron / GI frame. 5-4-10 | | | | | | | Number | | | |
| | Ware House | 1 | x | 4 | x | 1.00 | x | 1 | = | 4.00 | |
| | | | | | | | | Total | | 4.00 | |
| | | | | | | | | Say | | 4.00 | |
| 6 | Point wiring for light/fan/bell in 20 mm FRLS grade HMS PVC conduit with 1.5 sq.mm (2+1E) FRLSH grade copper wire with flush type switch and required accessories as per specification No: WG-PW/SW 1-7-3 | | | | | | | Number | | | |
| | Ware House | 1 | x | 4 | x | 1.00 | x | 1 | = | 4.00 | |
| | | | | | | | | Total | | 4.00 | |
| | | | | | | | | Say | | 4.00 | |



(192)

| | | | | | | | | | | | | |
|----|--|---|---|---|---|------|---|---|---|--------|--------|------|
| 7 | Supplying & erecting 10-12W, 230V integral type LED Lamp suitable for B-22 /E-27 base. 2-8-11 | | | | | | | | | Number | | |
| | Ware House | 2 | x | 2 | x | 1.00 | x | 1 | x | 1 | = | 4.00 |
| | | | | | | | | | | Total | | 4.00 |
| | | | | | | | | | | Say | | 4.00 |
| 8 | Supplying and erecting integrated LED street light fitting 18 to 22W IP65 & IK08 class having single piece pressure die-cast aluminium housing, having system lumens output of Min. 1800 Lumens, min. efficacy of 100 lumen/W, CRI>70, CCT upto 6500K, THD<10%, p.f.>0.95, operating range of 140-270V, inbuilt surge protection of 10 kV, Life class of 50,000 Hrs. at L70B50, including driver complete with 3 Years warranty as per specification No FGODF/ FLS2. 2-4-1 | | | | | | | | | | Number | |
| | Ware House | 2 | x | 2 | x | 1.00 | x | 1 | x | 1 | = | 4.00 |
| | | | | | | | | | | Total | | 4.00 |
| | | | | | | | | | | Say | | 4.00 |
| 9 | Supplying and erecting Street light bracket made from 40 mm. dia 'B' class G.I. Pipe, 0.6m. in length along with pole cap of 300 mm length and 80 mm dia duly welded with provided leads as per specification no. FG-BKT/BPC 2-7-2 | | | | | | | | | | Number | |
| | Ware House | 2 | x | 2 | x | 1.00 | x | 1 | x | 1 | = | 4.00 |
| | | | | | | | | | | Total | | 4.00 |
| | | | | | | | | | | Say | | 4.00 |
| 10 | Providing earthing with galvanized iron earth plate size 60 x 60 x 0.6 cm complete with all materials, testing & recording the results as per specification no. EA-EP 9-1-1 | | | | | | | | | | Number | |
| | Ware House | 1 | x | 1 | x | 1.00 | x | 1 | x | 1 | = | 1.00 |
| | | | | | | | | | | Total | | 1.00 |
| | | | | | | | | | | Say | | 1.00 |
| 11 | Providing pipe type earthing with 40mm. dia. G.I. pipe or 20 mm dia. G.I. Rod complete with all materials testing and recording the results as per specification no. EA-EP 9-1-4 | | | | | | | | | | Number | |
| | Ware House | 1 | x | 1 | x | 1.00 | x | 1 | x | 1 | = | 1.00 |
| | | | | | | | | | | Total | | 1.00 |
| | | | | | | | | | | Say | | 1.00 |
| 12 | Supplying, erecting & marking DPMCB 6A to 32A, C-series with rated short -circuit breaking capacity (Icn) 10kA in provided distribution board as per specification no. SW-SWR/MCB 5-3-6 | | | | | | | | | | Number | |
| | Ware House | 1 | x | 1 | x | 1.00 | x | 1 | x | 1 | = | 1.00 |
| | | | | | | | | | | Total | | 1.00 |
| | | | | | | | | | | Say | | 1.00 |
| 13 | Supplying, erecting & marking SPMCB 6A to 32A, B-series with rated short - circuit breaking capacity (Icn) 10kA in provided distribution board as per specification no. SW-SWR/MCB 5-3-3 | | | | | | | | | | Number | |
| | Ware House | 1 | x | 1 | x | 1.00 | x | 1 | x | 1 | = | 1.00 |
| | | | | | | | | | | Total | | 1.00 |
| | | | | | | | | | | Say | | 1.00 |



(199)

- 14 Supplying and erecting GI sheet 1.6 mm (16 SWG) having zinc coating of 350 microns with galvanization process compliance to IS 2629:1985 to be used for fabrication of boxes panel boards etc. including cutting, bending, drilling, welding, riveting etc. and painting with one coat of red lead paint and 2 coats of enamel paint. 6-1-6 Square Metre
- | | | | | | | | | | | | |
|------------|---|---|---|---|------|---|---|---|---|--------------|------|
| Ware House | 1 | x | 1 | x | 1.00 | x | 1 | x | 1 | = | 1.00 |
| | | | | | | | | | | Total | 1.00 |
| | | | | | | | | | | Say | 1.00 |
- 15 Supplying and erecting marine (Waterproof) plywood 18/19 mm thick fixed to wall or on provided panel board with necessary materials such as screws, wall fasteners, supports, nut bolts etc. complete with Square Metre
- | | | | | | | | | | | | |
|------------|---|---|---|---|------|---|---|---|---|--------------|------|
| Ware House | 1 | x | 1 | x | 1.00 | x | 1 | x | 1 | = | 1.00 |
| | | | | | | | | | | Total | 1.00 |
| | | | | | | | | | | Say | 1.00 |
- 16 Supplying & erecting triple pole and neutral distribution board (TPNDB), 3 pole/ 4 pole MCCB as incomer & outgoing SP MCB (12 poles) or TP MCB of 4 ways (12 poles), with door, 1.2mm thickness, surface/flush mounted, on iron/GI frame (vertical busbar type) as per specification no.SW-SWR/MCDBD1 5-4-15 Number
- | | | | | | | | | | | | |
|------------|---|---|---|---|------|---|---|---|---|--------------|------|
| Ware House | 2 | x | 1 | x | 1.00 | x | 1 | x | 1 | = | 2.00 |
| | | | | | | | | | | Total | 2.00 |
| | | | | | | | | | | Say | 2.00 |
- 17 Supplying & erecting G.I. pipe 'A' class 25 mm dia. erected for enclosing XLPE armoured cable on wall/pole as per specification no. CB-CE 7-6-1 Running Meter
- | | | | | | | | | | | | |
|------------|----|---|---|---|------|---|---|---|---|--------------|-------|
| Ware House | 10 | x | 1 | x | 1.00 | x | 1 | x | 1 | = | 10.00 |
| | | | | | | | | | | Total | 10.00 |
| | | | | | | | | | | Say | 10.00 |
- 18 Supplying & erecting G.I. pipe 'A' class 40 mm dia. erected for enclosing XLPE armoured cable on wall/pole as per specification no. CB-CE 7-6-2 Running Meter
- | | | | | | | | | | | | |
|------------|---|---|---|---|-------|---|---|---|---|--------------|-------|
| Ware House | 1 | x | 1 | x | 10.00 | x | 1 | x | 1 | = | 10.00 |
| | | | | | | | | | | Total | 10.00 |
| | | | | | | | | | | Say | 10.00 |
- 19 Supplying and laying (including excavation of suitable width & depth up to 90 cm) 75 mm outside dia. double wall corrugated pipes (DWC) of HDPE for enclosing cable below ground/road surface, to required depth complete. 7-6-10 Running Meter
- | | | | | | | | | | | | |
|------------|---|---|---|---|------|---|---|---|---|--------------|------|
| Ware House | 1 | x | 1 | x | 6.00 | x | 1 | x | 1 | = | 6.00 |
| | | | | | | | | | | Total | 6.00 |
| | | | | | | | | | | Say | 6.00 |
- 20 Supplying & erecting 18guage M.S. Box powder coated (4"x4") 3 way for mains connection. MR Number
- | | | | | | | | | | | | |
|------------|---|---|---|---|------|---|---|---|---|--------------|------|
| Ware House | 2 | x | 1 | x | 1.00 | x | 1 | x | 1 | = | 2.00 |
| | | | | | | | | | | Total | 2.00 |
| | | | | | | | | | | Say | 2.00 |



(134)

- 21 Supplying & erecting single compression type brass cable glands for 3 to 4 core 6 sq mm /2 to 4 core 10 sq mm for XLPE armoured cable as per specification No.CB-GL 7-7-2 Number
- | | | | | | | | | | | | | |
|------------|---|---|---|---|------|---|---|---|---|---|--------------|------|
| Ware House | 1 | x | 4 | x | 1.00 | x | 1 | x | 1 | = | 4.00 | |
| | | | | | | | | | | | Total | 4.00 |
| | | | | | | | | | | | Say | 4.00 |
- 22 Supplying and erecting Ceiling rose / Batten holder / Slanting holder / hanging cord switch / hanging bell push / pendant holder bakelite base 6A. erected on filled polypropylene board or polished double wooden block/ PVC junction box. 1-5-7 Number
- | | | | | | | | | | | | | |
|------------|---|---|---|---|------|---|---|---|---|---|--------------|------|
| Ware House | 1 | x | 1 | x | 1.00 | x | 1 | x | 1 | = | 1.00 | |
| | | | | | | | | | | | Total | 1.00 |
| | | | | | | | | | | | Say | 1.00 |
- 23 Point wiring for independent plug in 20 mm metal conduit with 1.5 sq.mm (2+1E) FRLSH grade copper wire, flush type switch, earthing and required accessories as per specification No: WG-PW/SW 1-7-2 Number
- | | | | | | | | | | | | | |
|------------|---|---|---|---|------|---|---|---|---|---|--------------|------|
| Ware House | 1 | x | 2 | x | 1.00 | x | 1 | x | 1 | = | 2.00 | |
| | | | | | | | | | | | Total | 2.00 |
| | | | | | | | | | | | Say | 2.00 |
- 24 Wiring for plug on board with Switch socket surface/concealed type, copper wiring and earthing and with modular accessories as per specification No: WGPW/ CW 1-7-26 Number
- | | | | | | | | | | | | | |
|------------|---|---|---|---|------|---|---|---|---|---|--------------|------|
| Ware House | 1 | x | 1 | x | 1.00 | x | 1 | x | 1 | = | 1.00 | |
| | | | | | | | | | | | Total | 1.00 |
| | | | | | | | | | | | Say | 1.00 |
- 25 Supplying and erecting mains with 2x2.5 sq.mm FRLSH copper PVC insulated wire laid in provided conduit/trunking/inside pole/Bus bars or any other places. as per specification No: WG-MA/BW 1-3-2 Running Meter
- | | | | | | | | | | | | | |
|------------|---|---|---|---|------|---|---|---|---|---|--------------|------|
| Ware House | 1 | x | 2 | x | 1.00 | x | 1 | x | 1 | = | 2.00 | |
| | | | | | | | | | | | Total | 2.00 |
| | | | | | | | | | | | Say | 2.00 |
- 26 Supplying and erecting mains with 2x4 sq.mm FRLSH copper PVC insulated wire laid in provided conduit/trunking/inside pole/Bus bars or any other places. as per specification No: WG-MA/BW 1-3-3 Running Meter
- | | | | | | | | | | | | | |
|------------|---|---|---|---|------|---|---|---|---|---|--------------|------|
| Ware House | 1 | x | 2 | x | 1.00 | x | 1 | x | 1 | = | 2.00 | |
| | | | | | | | | | | | Total | 2.00 |
| | | | | | | | | | | | Say | 2.00 |
- 27 Supplying and erecting modular type D.P. switch 32A with indicator, duly erected on provided plate and box with wiring connections complete. 1-6-8 Number
- | | | | | | | | | | | | | |
|------------|---|---|---|---|------|---|---|---|---|---|--------------|------|
| Ware House | 1 | x | 1 | x | 1.00 | x | 1 | x | 1 | = | 1.00 | |
| | | | | | | | | | | | Total | 1.00 |
| | | | | | | | | | | | Say | 1.00 |



(13)

| | | |
|------------|--|--------------|
| 28 | Supplying, erecting and marking double pole isolator only switch version of miniature circuit breaker of 40A with required wiring connections and lugs etc.in provided distribution board. 5-3-14 | Number |
| Ware House | 1 x 4 x 1.00 x 1 x 1 = | 4.00 |
| | Total | 4.00 |
| | Say | 4.00 |
| 29 | Supplying & erecting 3W, 230V integral type LED Lamp suitable for B-22 / E- 27 base. 2-8-9 | Number |
| Ware House | 1 x 1 x 1.00 x 1 x 1 = | 1.00 |
| | Total | 1.00 |
| | Say | 1.00 |
| 30 | Supplying and erecting IP65 and IK08 rated UV shielded polycarbonate waterproof and dustproof industrial grade LED fitting (4 feet) max. 36W with high transitivity diffuser with system lumens output of min. 4300 lumens , min. efficacy of 120 lumen/W, CRI>80, CCT upto 6500K, Beam Angle of 120 deg., Ripple<5%, THD<10%, p.f. >0.95, operating range of 120-270V, surge protection of 4 kV, Life class of 50,000 Hrs. at L70B50 , IP20 rated, including driver with auto cutoff & auto restart feature at 325V with end caps on PVC lock/wooden board with 3 years warranty. 2-2-1 | Number |
| Ware House | 1 x 4 x 1.00 x 1 x 1 = | 4.00 |
| | Total | 4.00 |
| | Say | 4.00 |
| 31 | Supplying and erecting regular/ standard model ceiling fan of 900 /1050 mm. sweep complete erected in position as per specification no. FG-FN/CF 2-10-2 | Number |
| Ware House | 1 x 1 x 1.00 x 1 x 1 = | 1.00 |
| | Total | 1.00 |
| | Say | 1.00 |
| 32 | Supplying and erecting ding dong / electronic musical type call bell with heavy duty coil suitable to operate on 230V A.C. supply erected on olished double wooden block/sunmica block of suitable size. 2-3-13 | Square Meter |
| Ware House | 1 x 1 x 1.00 x 1 x 1 = | 1.00 |
| | Total | 1.00 |
| | Say | 1.00 |
| 33 | Supplying and erecting Street light bracket made from 25 mm. dia 'B' class G.I. Pipe, 0.6m. in length along with pole cap of 300 mm length and 80 mm dia duly welded with provided leads as per specification no. FG-BKT/BPC 2-7-1 | #REF! |
| Ware House | 1 x 2 x 1.00 x 1 x 1 = | 2.00 |
| | Total | 2.00 |
| | Say | 2.00 |
| 34 | Supplying & erecting CRCA sheet metal one way enclosures of 1.2mm thickness suitable for DP MCB /TP MCB/FP MCB/RCCB/RCBO complete erected on angle iron/GI frame. 5-4-13 | Number |
| Ware House | 1 x 1 x 1.00 x 1 x 1 = | 1.00 |
| | Total | 1.00 |
| | Say | 1.00 |



(196)

35 Supplying, erecting and marking four pole isolators only switch version of miniature circuit breakers of 40A in provided distribution board. 5-3-18 Number

| | | | | | | | | | | | |
|------------|---|---|---|---|------|---|---|---|--------------|---|------|
| Ware House | 1 | x | 3 | x | 1.00 | x | 1 | x | 1 | = | 3.00 |
| | | | | | | | | | Total | | 3.00 |
| | | | | | | | | | Say | | 3.00 |

Rajendra Bhaskar
Chartered Engineer

Gaurav Rajendra Bhaskar
B.E.(Civil) A.M.I.E.
Chartered Engineer
AM3023322

Sai
Consulting Engineer

SAI CONSULTANT
Consulting Civil Engineer
Rahuri, Dist. Ahmednaga

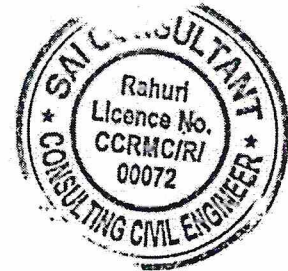

WARE HOUSE BUILDING UNIT 1000MT

Name Of Work :- Proposed Construction of 1000MT Warehouse Unit Building In G.No.138 Pulki, For Surya Tej Farmera Producer Co. Ltd, At- Sakrewadi, Tal-Oranabad, Dist- Oranabad(MH)

Director - Mr.Srinath Suryawanshi

SCHEDULE OF RC COLUMNS

| TYPE | SIZE IN MM | NO | REMARK |
|------|------------|----|--------------------------------------|
| C1 | 230x400 | 23 | ① LOW WALL |
| C2 | 230x400 | 6 | ② SIMPLE WALL |
| C4 | 230x200 | 4 | ③ TO BE PROVIDED ON DR @ BS FINISHES |
| C5 | 230x200 | 8 | ④ FOR PLATFORMS BELOW INRM |

SCHEDULE OF ROLLING SHUTTERS/VENTILATORS

| TYPE | SIZE IN M | NO | DESCRIPTION |
|------|-----------|----|---|
| V1 | 2.10x3.00 | 4 | ROLL & PAINT TYPE FIXED FROM INSIDE THESE ROLLING SHUTTERS RESPECIFICATION |
| V2 | 1.47x0.80 | 20 | ROLL VENTILATORS FULLY GLAZED WITH SHUTTERS (WHICH CAN BE OPENED TO BE FIXED BY POSITION @ 10mm C/C FIXED TO FRAME FROM OUTSIDE (TOP VENTILATORS) LONG WALL AND ONE IN EACH PANEL) |
| V3 | 0.87x0.80 | 44 | ROLL VENTILATORS FULLY GLAZED WITH SHUTTERS (WHICH CAN BE OPENED TO BE FIXED BY POSITION @ 10mm C/C FIXED TO FRAME FROM OUTSIDE (BOTTOM VENTILATORS) LONG WALL AND TWO IN EACH PANEL) |

Owner's declaration

I/We undersigned hereby confirm that I/we would abide by plans. I/We would execute the structure as per sanctioned plans. Also I/We would execute the work under supervision of proper technical person so as to ensure the quality and safety at the work site

owner (S) name and signature FOR: Mr.Srinath Suryawanshi
 Architect/Licensed Engineer/Supervisor name and signature

Srinath Suryawanshi
 SAI CONSULTANT
 Chartered Engineer
 Registered License no of Arch./Lic. Eng./Supervisor



SAI CONSULTANTS
 CONSULTING CIVIL ENGINEERS & CONTRACTORS
 10th Floor, C-5/111
 L.C.H.D. Market, Warananagar, Warananagar, Maharashtra

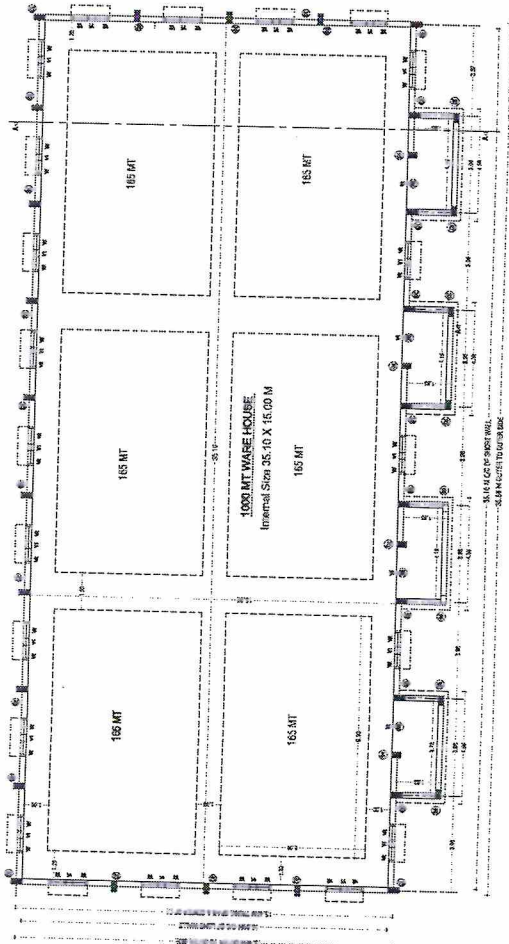
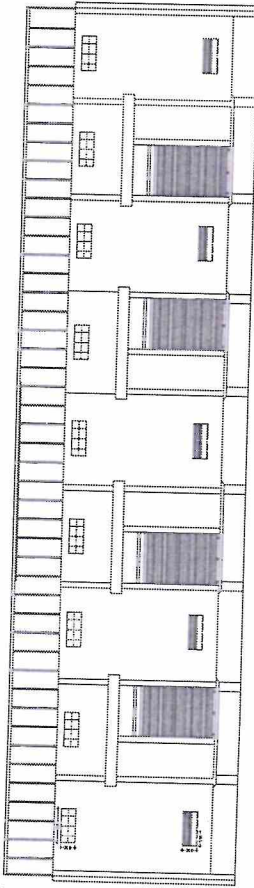
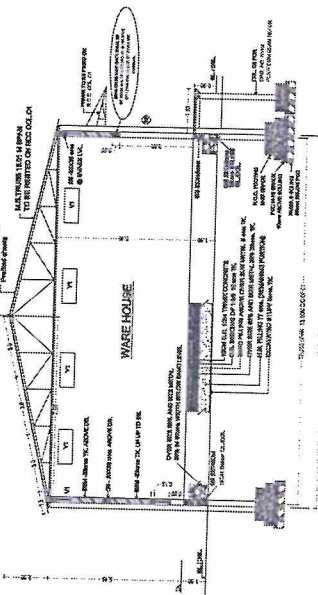

BUILT UP AREA CALCULATION

BUILDING SIZE PROPOSED SQ.MT.
 MAIN BUILDING 35.10 M X 15.00 M = 526.50 SQ.MT.
 PLATFORMS 4 NO. X 4.50 M X 1.85 M = 30.78 SQ.MT.
 TOTAL BUILT UP AREA = 557.28 SQ.MT.
 FLOOR AREA 35.10 X 15.00 M = 526.50 SQ.MT.

